

17,238 (1)



1565 Chenault Street, Dallas, Texas 75228

January 14, 2022

Office of County Commissioners  
PO BOX 1097  
Greenville, Texas 75403

FILED FOR RECORD  
at 1:30 o'clock P M

JAN 25 2022

BECKY LANDRUM  
County Clerk, Hunt County, Tex.  
By

**Aerial and / or Underground Crossing(s)  
Project PID 3152450**

Greetings,

Spectrum/Charter is requesting permission to construct and placement of fiber which may consist of both underground and aerial attachment to existing poles. This request is for multiple road crossings on county road 3118 which is located in Campbell, Hunt County, Texas.

Site location map and google plans are enclosed. The construction plans detail the proposed work. All road crossings will have a minimum vertical clearance of 18 feet.

If you have any questions, please contact me at any time.

Sincerely,

*Jason Kennedy*

Project Coordinator  
[Jason.kennedy@charter.com](mailto:Jason.kennedy@charter.com)  
Phone 903-513-2738

Submitted by:  
Dayna LaPoma / Jessie Hatley  
Project Coordinator / RDOF Coordinator  
[Dayna.lapoma@dfw-telecom.com](mailto:Dayna.lapoma@dfw-telecom.com)  
[Jessie.hatley@dfw-telecom.com](mailto:Jessie.hatley@dfw-telecom.com)

Enclosures

County Approval Section:

Approved: \_\_\_\_\_ Denied: \_\_\_\_\_

Authorized Signature: Date: 1-25-22

# Spectrum

NOTE:  
CONTRACTOR IS RESPONSIBLE TO MAINTAIN TRAFFIC CONTROL AS SET FORTH IN THE TEXAS MANUAL ON UNIFORM TRAFFIC CONTROL DEVICES FOR STREETS AND HIGHWAYS

Hunt County Road Crossing

Project consist of approximately:  
3 aerial crossing:  
227'  
98'  
327'

## GENERAL CONSTRUCTION NOTES

1. ALL CONSTRUCTION WORK WITHIN THE PUBLIC RIGHT-OF-WAY SHALL BE DONE IN ACCORDANCE WITH THE ORDINANCES AND REGULATIONS OF THE JURISDICTION IN WHICH THE WORK IS TO BE PERFORMED.
2. EXISTING UTILITY LOCATIONS SHOWN ARE TAKEN FROM AVAILABLE RECORDS AND MAY NOT BE ALL INCLUDING UTILITY LOCATIONS AND DEPTHS. CONTRACTOR IS ADVISED AND NOT BEYOND DUBIETY REFLECT THE SIZE AND LOCATION OF EACH INDIVIDUAL UTILITY. THE CONSTRUCTION CONTRACTOR SHALL ASSUME RESPONSIBILITY FOR OBTAINING ALL NECESSARY PERMITS AND THE PROTECTION OF ALL EXISTING FACILITIES SHOWN OR NOT. THE CONSTRUCTION CONTRACTOR SHALL ALSO ASSUME RESPONSIBILITY FOR OBTAINING ALL NECESSARY PERMITS AS A DIRECT RESULT OF THE CONSTRUCTION ACTIVITIES WHETHER THE FACILITY IS SHOWN ON THE DRAWING OR NOT.
3. THE CONSTRUCTION CONTRACTOR SHALL BE RESPONSIBLE FOR CONTACTING ALL DEPARTMENTS WITHIN THE JURISDICTION AND THE UTILITY COMPANIES AT LEAST TWO WORKING DAYS PRIOR TO THE COMMENCEMENT OF WORK. CALL BEFORE YOU DIG IS THE LAW.
4. IT SHALL BE THE RESPONSIBILITY OF THE CONSTRUCTION CONTRACTOR TO A) PREVENT DAMAGE TO PRIVATE AND PUBLIC PROPERTY, IS RESTORE ALL AREAS EFFECTED BY THE CONSTRUCTION TO ORIGINAL OR BETTER CONDITION.
5. SIGNAGING AND TRAFFIC CONTROL SHALL BE THE RESPONSIBILITY OF THE CONSTRUCTION CONTRACTOR AND SHALL CONFORM TO THE TEXAS MANUAL ON UNIFORM TRAFFIC CONTROL DEVICES. TRAFFIC FLOW AND ACCESS SHALL BE MAINTAINED THROUGH ALL PHASES OF CONSTRUCTION. THE CONSTRUCTION CONTRACTOR IS RESPONSIBLE FOR PROVIDING TRAFFIC SAFETY MEASURES FOR WORK ON THE PROJECT. THE WORK SITE SHALL BE SAFELY LIT AND BARRICADED AT NIGHT.
6. THE CONSTRUCTION CONTRACTOR SHALL ABIDE BY ALL APPLICABLE FEDERAL, STATE AND LOCAL LAWS CONCERNING EDUCATION. THE CONSTRUCTION CONTRACTOR SHALL PROVIDE ALL TRAFFIC SAFETY SYSTEMS THAT COMPLY WITH ALL LAWS CONCERNING EDUCATION. THE CONSTRUCTION CONTRACTOR SHALL BE FULLY RESPONSIBLE FOR ALL ASPECTS OF WORK RELATED TO EDUCATION.
7. ALL CONCRETE USED IN ANY ROADWAY SHALL BE IN COMPLIANCE WITH THE SPECIFIED GRADES OF CONCRETE IN THE STANDARD SPECIFICATIONS FOR PORTLAND CEMENT CONCRETE PAVEMENT AND 7.6.5 "QUALITY OF CONCRETE" AS INDICED BY THE REFERENCED TO THE NORTH CENTRAL TEXAS STANDARD SPECIFICATIONS FOR PUBLIC WORKS CONSTRUCTION - 2004. ALL OTHER CONCRETE SHALL BE CLASS A CONCRETE.
8. ALL REINFORCING STEEL AND CORREL BARS AS PRESENTED SHALL BE SUPPORTED AND MAINTAINED AT THE CORRECT CLEARANCES BY THE USE OF BAR CHAIRS OR OTHER APPROVED SUPPORT.
9. ALL CONCRETE MUST BE PLACED WITH A MINIMUM 45° OF COVER, UNLESS OTHERWISE SPECIFIED.
10. ALL BACKFILL WILL BE MECHANICALLY TAMPED IN LIFTS TO A DENSITY OF 95% PROCTOR. THE REQUIRED DENSITY WILL BE OBTAINED BY USING TAMPERS, RAMMERS OR ROLLING EQUIPMENT. LIFTS MAY VARY ACCORDING TO THE TYPE OF EQUIPMENT USED TO OBTAIN THE REQUIRED DENSITY. SAND AND GRAVEL FINE MATERIAL WILL BE USED FOR BACKFILL.

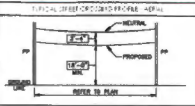
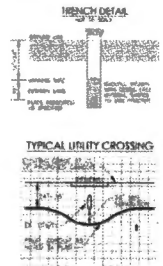

PREPARED BY: DFW TELECOM, INC

17,238 (2)  
**Spectrum**

1565 Chenault Street, Dallas, Texas 75228

January 19, 2022

Office of County Commissioners  
PO BOX 1097  
Greenville, Texas 75403

FILED FOR RECORD  
at 1:30 o'clock P M

JAN 25 2022

BECKY LANDRUM  
County Clerk, Hunt County, Tex.  
By 

**Aerial and / or Underground Crossing(s)  
Project PID 3291437**

Greetings,

Spectrum/Charter is requesting permission to construct and placement of fiber which may consist of both underground and aerial attachment to existing poles. This request is for multiple road crossings on county road 3131 which is located in Lone Oak, Hunt County, Texas.

Site location map and google plans are enclosed. The construction plans detail the proposed work. All road crossings will have a minimum vertical clearance of 18 feet.

If you have any questions, please contact me at any time.

Sincerely,

*Jason Kennedy*  
Project Coordinator  
[Jason.kennedy@charter.com](mailto:Jason.kennedy@charter.com)  
Phone 903-513-2738

Submitted by:  
Dayna LaPoma / Jessie Hatley  
Project Coordinator / RDOF Coordinator  
[Dayna.lapoma@dfw-telecom.com](mailto:Dayna.lapoma@dfw-telecom.com)  
[Jessie.hatley@dfw-telecom.com](mailto:Jessie.hatley@dfw-telecom.com)

Enclosures

County Approval Section:

Approved: \_\_\_\_\_ Denied: \_\_\_\_\_

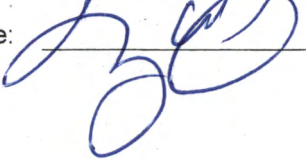
Authorized Signature:  \_\_\_\_\_ Date: 1-25-22

# Spectrum

NOTE  
CONTRACTOR IS RESPONSIBLE TO MAINTAIN TRAFFIC CONTROL AS SET FORTH IN THE LOCAL MANUAL ON UNIFORM TRAFFIC CONTROL DEVICES FOR STREETS AND HIGHWAYS

Hunt County Road Crossing

## PROJECT OVERVIEW PID 3291437 County Road Crossings CR 3131

### GENERAL CONSTRUCTION NOTES

1. ALL CONSTRUCTION WORK WITHIN THE PUBLIC RIGHT-OF-WAY SHALL BE DONE IN ACCORDANCE WITH THE ORDINANCES AND REGULATIONS OF THE JURISDICTION IN WHICH THE WORK IS TO BE PERFORMED.
2. EXISTING UTILITY LOCATIONS SHOWN ARE THOSE FROM AVAILABLE RECORDS AND MAY NOT BE ALL EXISTING UTILITY LOCATIONS AND DEPTHS. CONTRACTOR IS ADVISED TO VERIFY THE SIZE AND LOCATION OF EACH PARTICULAR UTILITY. THE CONSTRUCTION CONTRACTOR SHALL ASSUME RESPONSIBILITY FOR THE LOCATION OF ALL UTILITIES FACILITIES WHETHER SHOWN OR NOT. THE CONSTRUCTION CONTRACTOR SHALL ASSUME RESPONSIBILITY FOR REMOVAL OF ANY EXISTING FACILITY SHOWN AS A DIRECT RESULT OF THE CONSTRUCTION ACTIVITIES UNLESS THE FACILITY IS SHOWN ON THE DRAWINGS OR NOT.
3. THE CONSTRUCTION CONTRACTOR SHALL BE RESPONSIBLE FOR COORDINATING ALL DEPARTMENTS WITHIN THE JURISDICTION AND THE UTILITY COMPANIES AT LEAST TWO WEEKS PRIOR TO THE COMMENCEMENT OF WORK.  
CALL BEFORE YOU DIG  
811  
IT'S THE LAW
4. IT SHALL BE THE RESPONSIBILITY OF THE CONSTRUCTION CONTRACTOR TO AS PREVENT DAMAGE TO PRIVATE AND PUBLIC PROPERTY. IT IS REQUIRED ALL AREAS AFFECTED BY THE CONSTRUCTION TO BE REPAIRED OR BETTER CONDITION.
5. BARRICADES AND TRAFFIC CONTROL SHALL BE THE RESPONSIBILITY OF THE CONSTRUCTION CONTRACTOR AND SHALL CONFORM TO THE "LOCAL MANUAL ON UNIFORM TRAFFIC CONTROL DEVICES" TRAFFIC FLOW AND ACCESS SHALL BE MAINTAINED DURING ALL PHASES OF CONSTRUCTION. THE CONSTRUCTION CONTRACTOR IS RESPONSIBLE FOR PROVIDING TRAFFIC SAFETY MEASURES FOR WORK ON THE PROJECT THE WORK SITE SHALL BE BARRICADED AND BARRICADED AT NIGHT.
6. THE CONSTRUCTION CONTRACTOR SHALL ABIDE BY ALL APPLICABLE FEDERAL, STATE AND LOCAL LAWS CONCERNING EXCAVATION. THE CONSTRUCTION CONTRACTOR SHALL PROVIDE ALL NECESSARY SAFETY SYSTEMS THAT COMPLY WITH ALL LAWS CONCERNING EXCAVATION. THE CONSTRUCTION CONTRACTOR SHALL BE SOLELY RESPONSIBLE FOR ALL ASPECTS OF WORK RELATED TO EXCAVATION.
7. ALL CONCRETE USED IN ANY FOOTING SHALL BE IN COMPLIANCE WITH THE SPECIFIED CLASS OF CONCRETE IN THE STANDARD SPECIFICATIONS S.B. "PORTLAND CEMENT CONCRETE" AND 7.4.9 "QUALITY OF CONCRETE" AS ADVISED BY THE ARCHITECT TO THE LOCAL CERTIFICATED STANDARD SPECIFICATIONS FOR PUBLIC WORKS CONSTRUCTION - 2004. ALL OTHER CONCRETE SHALL BE CLASS A CONCRETE.
8. ALL REINFORCING STEEL AND BARS IN FOOTING SHALL BE SUPPORTED AND MAINTAINED AT THE CORRECT CLEARANCES BY THE USE OF AIR CHAIRS OR OTHER APPROVED SUPPORT.
9. ALL CONDUIT MUST BE PLACED WITH A MINIMUM 4" OF COVER UNLESS OTHERWISE SPECIFIED.
10. ALL BACKFILLING WILL BE MECHANICALLY TAMPED IN LOTS TO A DENSITY OF THE PROCTOR. THE REQUIRED DENSITY WILL BE DETERMINED BY USING STANDARD METHODS OR MILLING EQUIPMENT. LOTS MAY VARY ACCORDING TO THE TYPE OF EQUIPMENT USED TO OBTAIN THE REQUIRED DENSITY. SHED AND DESIGN PRICE MATERIALS SHALL BE USED FOR BACKFILL.

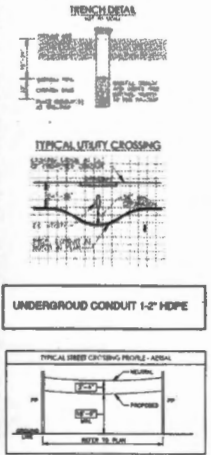
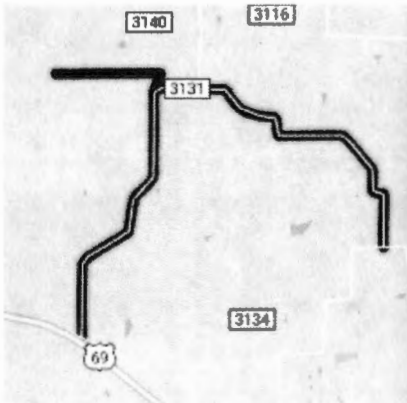

# Spectrum

NOTE  
CONTRACTOR IS RESPONSIBLE TO MAINTAIN TRAFFIC CONTROL DEVICES FOR STREETS AND HIGHWAYS

Hunt County Road Crossing

Project consist of approximately  
2 aerial crossings:  
346'  
81'

**GENERAL CONSTRUCTION NOTES**

1. ALL CONSTRUCTION WORK WITHIN THE PUBLIC RIGHT-OF-WAY SHALL BE DONE IN ACCORDANCE WITH THE ORDINANCES AND RESOLUTIONS OF THE MUNICIPALITY IN WHICH THE WORK IS TO BE PERFORMED.
2. EXISTING UTILITY LOCATIONS SHOWN ARE BASED UPON AVAILABLE RECORDS AND MAY NOT BE ALL INCLUDING UTILITY LOCATIONS ARE GENERALLY SHOWN IN RED AND ARE NOT ACCURATELY REFLECT THE SIZE AND LOCATION OF EACH PARTICULAR UTILITY. THE CONSTRUCTION CONTRACTOR SHALL ASSUME RESPONSIBILITY FOR ACTUAL LINE LOCATIONS IN THE FIELD AND THE PROTECTION OF ALL EXISTING FACILITIES WHETHER SHOWN OR NOT. THE CONSTRUCTION CONTRACTOR SHALL ALSO ASSUME RESPONSIBILITY FOR FITNESS TO ANY EXISTING FACILITY SHOWN AS A DIRECT RESULT OF THE CONSTRUCTION ACTIVITIES WHETHER THE FACILITY IS SHOWN ON THE DRAWINGS OR NOT.
3. THE CONSTRUCTION CONTRACTOR SHALL BE RESPONSIBLE FOR CONTACTING ALL DEPARTMENTS WITHIN THE MUNICIPALITY AND THE UTILITY COMPANIES AT LEAST TWO WEEKS PRIOR TO THE COMMENCEMENT OF WORK.  
CALL BEFORE YOU DIG  
811  
IT'S THE LAW
4. IT SHALL BE THE RESPONSIBILITY OF THE CONSTRUCTION CONTRACTOR TO A) PREVENT DAMAGE TO PRIVATE AND PUBLIC PROPERTY TO REMOVAL ALL AREAS EFFECTED BY THE CONSTRUCTION TO ORIGINAL OR BETTER CONDITION.
5. OVERLOADING AND TRAFFIC CONTROL SHALL BE THE RESPONSIBILITY OF THE CONSTRUCTION CONTRACTOR AND SHALL CONFORM TO THE TEXAS MANUAL ON UNIFORM TRAFFIC CONTROL DEVICES' TRAFFIC FLOW AND ACCESS SHALL BE MAINTAINED DURING ALL PHASES OF CONSTRUCTION. THE CONSTRUCTION CONTRACTOR IS RESPONSIBLE FOR PROVIDING TRAFFIC SAFETY MEASURES FOR WORK ON THE PROJECT. THE WORK SITE SHALL BE SUITABLY LIT AND BARRICADED AT NIGHT.
6. THE CONSTRUCTION CONTRACTOR SHALL ABIDE BY ALL APPLICABLE FEDERAL, STATE AND LOCAL LAWS GOVERNING CONSTRUCTION. THE CONSTRUCTION CONTRACTOR SHALL PROVIDE ALL TRUCK SAFETY SYSTEMS THAT COMPLY WITH ALL LAWS GOVERNING OPERATORS. THE CONSTRUCTION CONTRACTOR SHALL BE SOLELY RESPONSIBLE FOR ALL ASPECTS OF WORK RELATED TO EXHAUSTION.
7. ALL CONCRETE USED IN ANY ROADWAY SHALL BE IN COMPLIANCE WITH THE SPECIFIED CLASSES OF CONCRETE IN THE STANDARD SPECIFICATIONS U.S. PORTLAND CEMENT CONCRETE, FRESHMENT AND 7.4.5 "QUALITY OF CONCRETE" AS INDICATED BY THE ADDENDUM TO THE NORTH CENTRAL TEXAS STANDARD SPECIFICATIONS FOR PUBLIC WORKS CONSTRUCTION - 2004. ALL OTHER CONCRETE SHALL BE CLASS A CONCRETE.
8. ALL REINFORCING STEEL AND CONTROL BARS IN PAVEMENT SHALL BE SUPPORTED AND MAINTAINED AT THE CORRECT CLEARANCES BY THE USE OF BAR CHAIRS OR OTHER APPROVED SUPPORT.
9. ALL CURBS MUST BE PLACED WITH A MINIMUM 4" OF CONCRETE UNLESS OTHERWISE SPECIFIED.
10. ALL BACKFILLING WILL BE MECHANICALLY TAMPED IN LIFTS TO A DENSITY OF 95% PROCTOR. THE REQUIRED DENSITY WILL BE DETERMINED BY VIBRO TAMPER, NUMBER OF BEATING EQUIPMENT, LIFTS MAY VARY ACCORDING TO THE TYPE OF EQUIPMENT USED TO OBTAIN THE REQUIRED DENSITY. SAND AND GRAINS FREE MATERIAL WILL BE USED FOR BACKFILL.

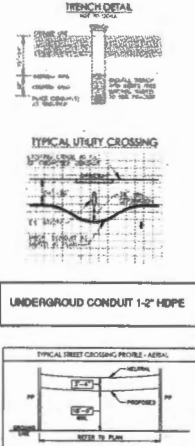

PREPARED BY: DFW TELECOM, INC



# Spectrum

NOTE  
CONTRACTOR IS RESPONSIBLE TO MAINTAIN TRAFFIC CONTROL AS SET FORTH IN THE TEXAS MANUAL ON UNIFORM TRAFFIC CONTROL DEVICES FOR STREETS AND HIGHWAYS.

Hunt County Road Crossing

Project consist of approximately  
2 aerial crossings:  
220'  
142'

- ### GENERAL CONSTRUCTION NOTES
1. ALL CONSTRUCTION WORK WITHIN THE PUBLIC RIGHT-OF-WAY SHALL BE DONE IN ACCORDANCE WITH THE ORDINANCES AND REGULATIONS OF THE JURISDICTION IN WHICH THE WORK IS TO BE PERFORMED.
  2. EXISTING UTILITY LOCATIONS SHOWN ARE TAKEN FROM AVAILABLE RECORDS AND MAY NOT BE ALL INCLUDING UTILITY LOCATIONS ARE OCCASIONALLY REVEALED BY HAND AND MAY NOT ACCURATELY REFLECT THE SIZE AND LOCATION OF EACH PARTICULAR UTILITY. THE CONSTRUCTION CONTRACTOR SHALL ASSUME RESPONSIBILITY FOR VERIFYING THE LOCATION OF ALL UTILITIES PRIOR TO ANY EXCAVATION WORK. THE CONSTRUCTION CONTRACTOR SHALL ASSUME RESPONSIBILITY FOR REMEDY TO ANY EXISTING FACILITY DAMAGED AS A DIRECT RESULT OF THE CONSTRUCTION ACTIVITIES WHETHER THE FACILITY IS SHOWN ON THE DRAWINGS OR NOT.
  3. THE CONSTRUCTION CONTRACTOR SHALL BE RESPONSIBLE FOR CONTACTING ALL OWNERS WITHIN THE JURISDICTION AND THE UTILITY COMPANIES AT LEAST 14 DAYS PRIOR TO THE COMMENCEMENT OF WORK.  
CALL BEFORE YOU DIG  
811  
IT'S THE LAW
  4. IT SHALL BE THE RESPONSIBILITY OF THE CONSTRUCTION CONTRACTOR TO AVOID DAMAGE TO PRIVATE AND PUBLIC PROPERTY, TO RESTORE ALL AREAS DISTURBED BY THE CONSTRUCTION TO ORIGINAL OR BETTER CONDITION.
  5. SHORING AND TRAFFIC CONTROL SHALL BE THE RESPONSIBILITY OF THE CONSTRUCTION CONTRACTOR AND SHALL CONFORM TO THE "ROAD MANUAL ON UNIFORM TRAFFIC CONTROL DEVICES" TRAFFIC FLOW AND ACCESS SHALL BE MAINTAINED DURING ALL PHASES OF CONSTRUCTION. THE CONSTRUCTION CONTRACTOR IS RESPONSIBLE FOR PROVIDING TRAFFIC SAFETY MEASURES FOR WORK ON THE PROJECT. THE WORK SITE SHALL BE SURVEILLED AND SHORING AS NECESSARY.
  6. THE CONSTRUCTION CONTRACTOR SHALL ABIDE BY ALL APPLICABLE FEDERAL, STATE AND LOCAL LAWS GOVERNING EXCAVATION. THE CONSTRUCTION CONTRACTOR SHALL PROVIDE ALL TRAFFIC SAFETY SYSTEMS THAT COMPLY WITH ALL LAWS GOVERNING EXCAVATION. THE CONSTRUCTION CONTRACTOR SHALL BE SOLELY RESPONSIBLE FOR ALL ASPECTS OF WORK RELATED TO EXCAVATION.
  7. ALL CONCRETE USED IN ANY FOOTING SHALL BE IN COMPLIANCE WITH THE SPECIFIED CLASS OF CONCRETE IN THE STANDARD SPECIFICATIONS FOR PORTLAND CEMENT CONCRETE AND 7.05 "QUALITY OF CONCRETE" AS ADVICE BY THE MEMBERS TO THE NORTH CENTRAL TEST METHODS SPECIFICATIONS FOR PUBLIC WORKS CONSTRUCTION - 2004. ALL OTHER CONCRETE SHALL BE CLASS A CONCRETE.
  8. ALL REINFORCING STEEL AND BOLT, BARS IF PROVIDED SHALL BE SUPPORTED AND MAINTAINED AT THE CORRECT CLEARANCES BY THE USE OF BAR CHAIRS OR OTHER APPROVED SUPPORT.
  9. ALL CONDUIT MUST BE PLACED WITH A MINIMUM 4" OF COVER, UNLESS OTHERWISE SPECIFIED.
  10. ALL BACKFILL WILL BE MECHANICALLY TAMPED IN LIFTS TO A DENSITY OF 95% PROCTOR. THE REQUIRED DENSITY WILL BE OBTAINED BY USING SHAKERS, ROLLERS OR ROLLING EQUIPMENT. LIFTS MAY VARY ACCORDING TO THE TYPE OF EQUIPMENT USED TO OBTAIN THE REQUIRED DENSITY. SAND AND GRADE FILL MATERIALS WILL BE USED FOR SHOVELL.

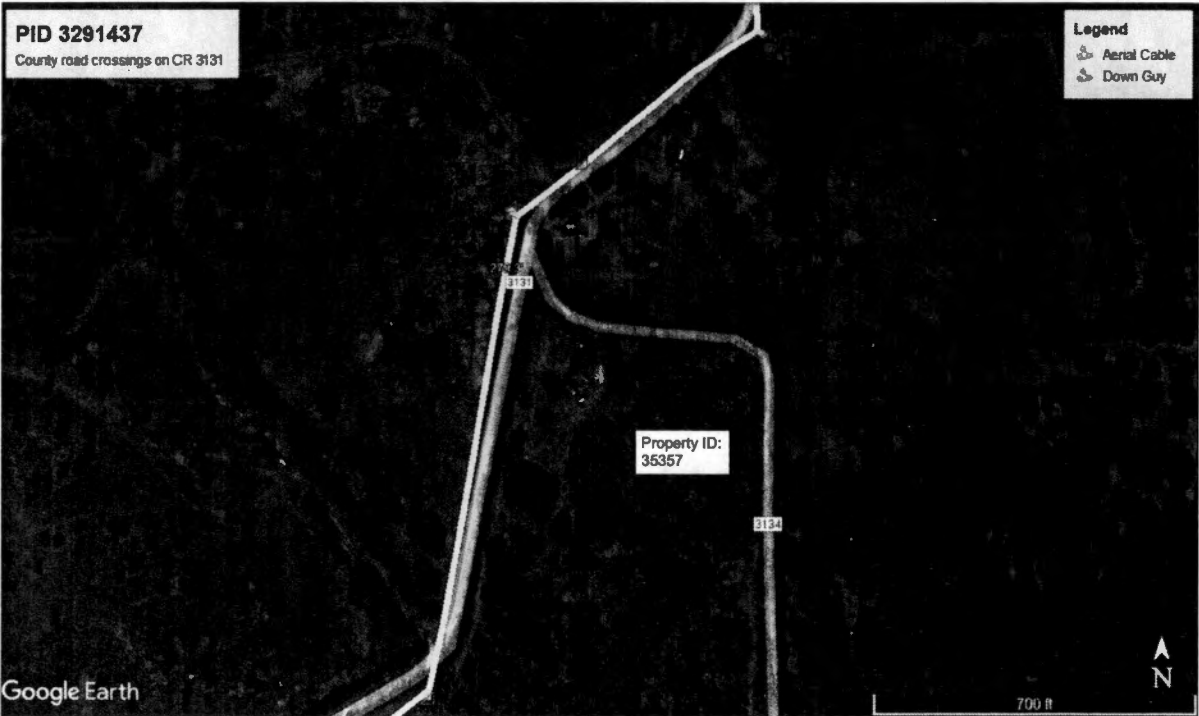

- ### Legend
- Aerial Cable
  - Down Guy

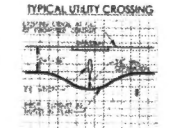
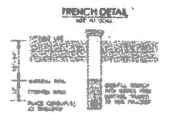

UNDERGROUND CONDUIT 1-2" HDPE

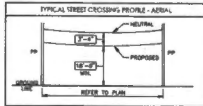

PREPARED BY: DFW TELECOM, INC

# Spectrum

NOTE  
CONTRACTOR IS RESPONSIBLE TO MAINTAIN TRAFFIC CONTROL AS SET FORTH IN THE TEXAS MANUAL ON UNIFORM TRAFFIC CONTROL DEVICES FOR STREETS AND HIGHWAYS

Hunt County Road Crossing

Project consist of approximately  
1 aerial crossings:  
298'

## GENERAL CONSTRUCTION NOTES

1. ALL CONSTRUCTION WORK WITHIN THE PUBLIC RIGHT-OF-WAY SHALL BE DONE IN ACCORDANCE WITH THE ORDINANCES AND REGULATIONS OF THE MUNICIPALITY IN WHICH THE WORK IS TO BE PERFORMED.
2. EXISTING UTILITY LOCATIONS SHOWN ARE BASED FROM AVAILABLE RECORDS AND MAY NOT BE ALL UTILITIES. UTILITY LOCATIONS ARE GENERALLY SHOWN IN RED AND DO NOT ACCURATELY REFLECT THE SIZE AND LOCATION OF EACH PARTICULAR UTILITY. THE CONSTRUCTION CONTRACTOR SHALL OBTAIN EQUIPMENT FOR SOIL LINE LOCATING IN THE FIELD AND THE PROTECTION OF ALL EXISTING FACILITIES WHETHER SHOWN OR NOT. THE CONSTRUCTION CONTRACTOR SHALL ALSO ASSUME RESPONSIBILITY FOR REMEDY TO ANY EXISTING FACILITY DAMAGED AS A DIRECT RESULT OF THE CONSTRUCTION ACTIVITIES WHETHER THE FACILITY IS SHOWN ON THE DRAWINGS OR NOT.
3. THE CONSTRUCTION CONTRACTOR SHALL BE RESPONSIBLE FOR CONTACTING ALL DEPARTMENTS WITHIN THE MUNICIPALITY AND THE UTILITY COMPANIES AT LEAST TWO WORKING DAYS PRIOR TO THE COMMENCEMENT OF WORK.  
CALL BEFORE YOU DIG  
IT'S THE LAW  
811
4. \* SHALL BE THE RESPONSIBILITY OF THE CONSTRUCTION CONTRACTOR TO A) PREVENT DAMAGE TO PRIVATE AND PUBLIC PROPERTY. B) RESTORE ALL AREAS AFFECTED BY THE CONSTRUCTION TO ORIGINAL OR BETTER CONDITION.
5. BARRICADES AND TRAFFIC CONTROL SHALL BE THE RESPONSIBILITY OF THE CONSTRUCTION CONTRACTOR AND SHALL CONFORM TO THE TEXAS MANUAL ON UNIFORM TRAFFIC CONTROL DEVICES. TRAFFIC FLOW AND ACCESS SHALL BE MAINTAINED DURING ALL PHASES OF CONSTRUCTION. THE CONSTRUCTION CONTRACTOR IS RESPONSIBLE FOR PROVIDING TRAFFIC SAFETY MEASURES FOR WORK ON THE PROJECT. THE WORK SITE SHALL BE SUITABLY LIGHT AND BARRICADED AT NIGHT.
6. THE CONSTRUCTION CONTRACTOR SHALL ABIDE BY ALL APPLICABLE FEDERAL, STATE AND LOCAL LAWS CONCERNING EXCAVATION. THE CONSTRUCTION CONTRACTOR SHALL PROVIDE ALL BRANCH SAFETY SYSTEMS THAT COMPLY WITH ALL LAND COVERING REQUIREMENTS. THE CONSTRUCTION CONTRACTOR SHALL BE SOLELY RESPONSIBLE FOR ALL ASPECTS OF WORK RELATED TO EXCAVATION.
7. ALL CONCRETE USED IN ANY ROADWAY SHALL BE IN COMPLIANCE WITH THE SPECIFIED CLASS OF CONCRETE IN THE STANDARD SPECIFICATIONS 2.0 "PORTLAND CEMENT CONCRETE, FINISHED" AND 7.4.3 "QUALITY OF CONCRETE" AS ADOPTED BY THE AGGREGATE TO THE NORTH CENTRAL STATES STANDARD SPECIFICATIONS FOR PUBLIC WORKS CONSTRUCTION - 2004. ALL OTHER CONCRETE SHALL BE CLASS A CONCRETE.
8. ALL REINFORCING STEEL AND CORREL BARS IN PAVEMENT SHALL BE SUPPORTED AND UNIFORMED AT THE CORRECT CLEARANCES BY THE USE OF BAR CHAIRS OR OTHER APPROVED SUPPORT.
9. ALL CORREL MUST BE PLACED WITH A MINIMUM 4" OF COVER UNLESS OTHERWISE SPECIFIED.
10. ALL BACKFILL SHALL BE MECHANICALLY TAMPED IN LIFTS TO A DENSITY OF 95% PROCTOR. THE REQUIRED DENSITY WILL BE OBTAINED BY USING TAMPERS, MANIPULATED OR ROLLING EQUIPMENT. LIFTS MAY VARY ACCORDING TO THE TYPE OF EQUIPMENT USED TO OBTAIN THE REQUIRED DENSITY. SAND AND DEBRIS FREE MATERIAL WILL BE USED FOR BACKFILL.

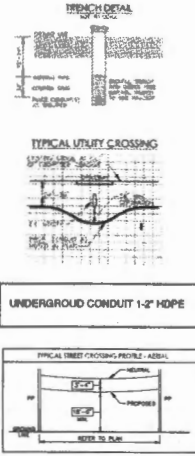

PREPARED BY: DFW TELECOM, INC

17,238 (3)



1565 Chenault Street, Dallas, Texas 75228

January 19, 2022

Office of County Commissioners  
PO BOX 1097  
Greenville, Texas 75403

FILED FOR RECORD  
at 1:30 o'clock P M

JAN 25 2022

BECKY LANDRUM  
County Clerk, Hunt County, Tex.  
By

**Aerial and / or Underground Crossing(s)  
Project PID 3291437**

Greetings,

Spectrum/Charter is requesting permission to construct and placement of fiber which may consist of both underground and aerial attachment to existing poles. This request is for multiple road crossings on county road 3132 which is located in Lone Oak, Hunt County, Texas.

Site location map and google plans are enclosed. The construction plans detail the proposed work. All road crossings will have a minimum vertical clearance of 18 feet.

If you have any questions, please contact me at any time.

Sincerely,

*Jason Kennedy*  
Project Coordinator  
[Jason.kennedy@charter.com](mailto:Jason.kennedy@charter.com)  
Phone 903-513-2738

Submitted by:  
Dayna LaPoma / Jessie Hatley  
Project Coordinator / RDOF Coordinator  
[Dayna.lapoma@dfw-telecom.com](mailto:Dayna.lapoma@dfw-telecom.com)  
[Jessie.hatley@dfw-telecom.com](mailto:Jessie.hatley@dfw-telecom.com)

Enclosures

County Approval Section:

Approved: \_\_\_\_\_ Denied: \_\_\_\_\_

Authorized Signature:  \_\_\_\_\_ Date: 1-25-22



# Spectrum

**NOTE**  
CONTRACTOR IS RESPONSIBLE TO MAINTAIN TRAFFIC CONTROL AS SET FORTH IN THE TEXAS MANUAL ON UNIFORM TRAFFIC CONTROL DEVICES FOR STREETS AND HIGHWAYS.

Hunt County Road Crossing

Project consist of approximately:  
2 aerial crossings:  
150'  
73'

### GENERAL CONSTRUCTION NOTES

1. ALL CONSTRUCTION WORK WITHIN THE PUBLIC RIGHT-OF-WAY SHALL BE DONE IN ACCORDANCE WITH THE ORDINANCES AND REGULATIONS OF THE MUNICIPALITY IN WHICH THE WORK IS TO BE PERFORMED.
2. EXISTING UTILITY LOCATIONS SHOWN ARE THOSE FROM AVAILABLE RECORDS AND MAY NOT BE ALL INCLUDING. UTILITY LOCATIONS ARE GENERALLY SHOWN BY REFERENCE AND MAY NOT ACCURATELY REFLECT THE SIZE AND LOCATION OF EACH PARTICULAR UTILITY. THE CONSTRUCTION CONTRACTOR SHALL ASSUME RESPONSIBILITY FOR ACTUAL LINE LOCATIONS IN THE FIELD AND THE PROTECTION OF ALL EXISTING FACILITIES WHETHER SHOWN OR NOT. THE CONSTRUCTION CONTRACTOR SHALL ASSUME RESPONSIBILITY FOR DAMAGES TO ANY EXISTING FACILITY OWNED AS A RESULT RESULT OF THE CONSTRUCTION ADVANCES WHETHER THE FACILITY IS SHOWN ON THE DRAWINGS OR NOT.
3. THE CONSTRUCTION CONTRACTOR SHALL BE RESPONSIBLE FOR CONDUCTING ALL SURVEYS WITHIN THE MUNICIPALITY AND THE UTILITY COMPANIES AT LEAST TWO WORKING DAYS PRIOR TO THE COMMENCEMENT OF WORK. CALL BEFORE YOU DIG IS THE LAW.
4. IF SHALL BE THE RESPONSIBILITY OF THE CONSTRUCTION CONTRACTOR TO: A) PREVENT DAMAGE TO FENCE AND PUBLIC PROPERTY; B) RESTORE ALL AREAS AFFECTED BY THE CONSTRUCTION TO ORIGINAL OR BETTER CONDITION.
5. BARRICADES AND TRAFFIC CONTROL SHALL BE THE RESPONSIBILITY OF THE CONSTRUCTION CONTRACTOR AND SHALL CONFORM TO THE "TEXAS MANUAL ON UNIFORM TRAFFIC CONTROL DEVICES". TRAFFIC FLOW AND ACCESS SHALL BE MAINTAINED DURING ALL PHASES OF CONSTRUCTION. THE CONSTRUCTION CONTRACTOR IS RESPONSIBLE FOR MAINTAINING TRAFFIC SAFETY REQUIREMENTS FOR WORK ON THE PROJECT. THE WORK SITE SHALL BE SUITABLY LIGHT AND BARRICADED AT NIGHT.
6. THE CONSTRUCTION CONTRACTOR SHALL ABIDE BY ALL APPLICABLE FEDERAL, STATE AND LOCAL LAWS GOVERNING CONSTRUCTION. THE CONSTRUCTION CONTRACTOR SHALL PROVIDE ALL TRAFFIC SAFETY DEVICES THAT COMPLY WITH ALL LAWS GOVERNING EQUIPMENT. THE CONSTRUCTION CONTRACTOR SHALL BE SOLELY RESPONSIBLE FOR ALL ASPECTS OF WORK RELATED TO CONSTRUCTION.
7. ALL CONCRETE USED IN ANY ROADWAY SHALL BE IN COMPLIANCE WITH THE SPECIFIED CLASS OF CONCRETE IN THE STANDARD SPECIFICATIONS FOR PORTLAND CEMENT CONCRETE, PROVISIONS AND T.A.B. QUALITY OF CONCRETE, AS REVISED BY THE AMENDMENTS TO THE 2004 CENTRAL TEXAS STANDARD SPECIFICATIONS FOR PUBLIC WORKS CONSTRUCTION - 2004. ALL OTHER CONCRETE SHALL BE CLASS A CONCRETE.
8. ALL REINFORCING STEEL AND CONCRETE SHALL BE PROVIDED SHALL BE SUPPORTED AND MAINTAINED AT THE CORRECT CLEARANCES BY THE USE OF SUE CHAIRS OR OTHER APPROVED SUPPORT.
9. ALL CONCRETE MUST BE PLACED WITH A MINIMUM 4" OF COVER, UNLESS OTHERWISE SPECIFIED.
10. ALL BACKFILL WILL BE MECHANICALLY TAMPED IN LIFTS TO A DENSITY OF 95% PROCTOR. THE REQUIRED DENSITY WILL BE OBTAINED BY USING TAMPERS, ROLLERS OR ROLLING EQUIPMENT. LIFTS MAY VARY ACCORDING TO THE TYPE OF EQUIPMENT USED TO OBTAIN THE REQUIRED DENSITY. SAND AND GRADE FINE MATERIAL WILL BE USED FOR BACKFILL.

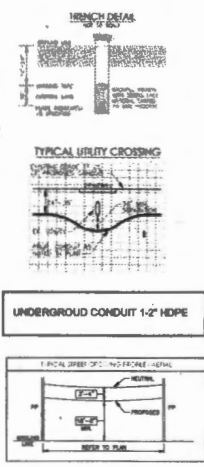

PREPARED BY: DFW TELECOM, INC

17,238 (4)

# Spectrum

1565 Chenault Street, Dallas, Texas 75228

January 19, 2022

Office of County Commissioners  
PO BOX 1097  
Greenville, Texas 75403

FILED FOR RECORD  
at 1:30 o'clock P M

JAN 25 2022

BECKY LANDRUM  
County Clerk, Hunt County, Tex.  
By 

**Aerial and / or Underground Crossing(s)  
Project PID 3291437**

Greetings,

Spectrum/Charter is requesting permission to construct and placement of fiber which may consist of both underground and aerial attachment to existing poles. This request is for multiple road crossings on county road 3133 which is located in Lone Oak, Hunt County, Texas.

Site location map and google plans are enclosed. The construction plans detail the proposed work. All road crossings will have a minimum vertical clearance of 18 feet.

If you have any questions, please contact me at any time.

Sincerely,

*Jason Kennedy*  
Project Coordinator  
[Jason.kennedy@charter.com](mailto:Jason.kennedy@charter.com)  
Phone 903-513-2738

Submitted by:  
Dayna LaPoma / Jessie Hatley  
Project Coordinator / RDOF Coordinator  
[Dayna.lapoma@dfw-telecom.com](mailto:Dayna.lapoma@dfw-telecom.com)  
[Jessie.hatley@dfw-telecom.com](mailto:Jessie.hatley@dfw-telecom.com)

Enclosures

County Approval Section:

Approved:  Denied:

Authorized Signature:  Date: 1-25-22

# Spectrum

NOTE  
CONTRACTOR IS RESPONSIBLE TO MAINTAIN TRAFFIC CONTROL AS SET FORTH IN THE TEXAS MANUAL ON UNIFORM TRAFFIC CONTROL DEVICES FOR STREETS AND HIGHWAYS

Hunt County Road Crossing

Project consist of approximately:  
2 aerial crossings:  
290'  
68'

### GENERAL CONSTRUCTION NOTES

1. ALL CONSTRUCTION WORK WITHIN THE PUBLIC RIGHT-OF-WAY SHALL BE DONE IN ACCORDANCE WITH THE ORDINANCES AND REGULATIONS OF THE JURISDICTION IN WHICH THE WORK IS TO BE PERFORMED.
2. EXISTING UTILITY LOCATIONS SHOWN ARE THOSE FROM AVAILABLE RECORDS AND MAY NOT BE ALL INCLUDING. UTILITY LOCATIONS ARE GENERALLY SHOWN AS REFERENCE AND NOT ACCURATELY REFLECT THE SIZE AND LOCATION OF EACH PARTICULAR UTILITY. THE CONSTRUCTION CONTRACTOR SHALL ASSUME RESPONSIBILITY FOR THE ACTUAL LINE LOCATED IN THE FIELD AND THE PROTECTION OF ALL EXISTING UTILITIES WHETHER SHOWN OR NOT. THE CONSTRUCTION CONTRACTOR SHALL ASSUME RESPONSIBILITY FOR DAMAGES TO ANY EXISTING UTILITY RESULTING AS A DIRECT RESULT OF THE CONSTRUCTION ACTIVITIES WHETHER THE FACILITY IS SHOWN ON THE DRAWINGS OR NOT.
3. THE CONSTRUCTION CONTRACTOR SHALL BE RESPONSIBLE FOR OBTAINING ALL NECESSARY PERMITS BY THE SUBSCRIBER AND THE UTILITY COMPANIES AT LEAST 30 BUSINESS DAYS PRIOR TO THE COMMENCEMENT OF WORK. CALL BEFORE YOU DIG (811) IT'S THE LAW.
4. IT SHALL BE THE RESPONSIBILITY OF THE CONSTRUCTION CONTRACTOR TO A) PREVENT DAMAGE TO PRIVATE AND PUBLIC PROPERTY, TO RESTORE ALL AREAS AFFECTED BY THE CONSTRUCTION TO ORIGINAL OR BETTER CONDITION.
5. BARRENCING AND TRAFFIC CONTROL SHALL BE THE RESPONSIBILITY OF THE CONSTRUCTION CONTRACTOR AND SHALL CONFORM TO THE "TEXAS MANUAL ON UNIFORM TRAFFIC CONTROL DEVICES". TRAFFIC FLOW AND ACCESS SHALL BE MAINTAINED DURING ALL PHASES OF CONSTRUCTION. THE CONSTRUCTION CONTRACTOR IS RESPONSIBLE FOR PROVIDING TRAFFIC SAFETY MEASURES FOR WORK ON THE PROJECT. THE WORK SITE SHALL BE SAFELY LIT AND BARRENCED AT NIGHT.
6. THE CONSTRUCTION CONTRACTOR SHALL ABIDE BY ALL APPLICABLE FEDERAL, STATE AND LOCAL LAWS GOVERNING EDUCATION. THE CONSTRUCTION CONTRACTOR SHALL PROVIDE ALL TRAFFIC SAFETY STUDIES THAT COMPLY WITH ALL LAWS GOVERNING EDUCATION. THE CONSTRUCTION CONTRACTOR SHALL BE SOLELY RESPONSIBLE FOR ALL ASPECTS OF WORK RELATED TO EDUCATION.
7. ALL CONCRETE USED IN ANY REBARRY SHALL BE IN COMPLIANCE WITH THE SPECIFIED CLASS OF CONCRETE IN THE SPECIFICATIONS SPECIFICALLY "PORTLAND CEMENT CONCRETE FINISHMENT" AND "CLASS 'QUALITY OF CONCRETE' AS INDICATED BY THE ACCESSORIES TO THE REBARRY SYSTEM. CLASS SPECIFICATIONS FOR PUBLIC WORKS CONSTRUCTION - SHALL ALL OTHER CONCRETE SHALL BE CLASS A CONCRETE.
8. ALL REBARRYING STEEL AND CABLE BARS IN REBARRY SHALL BE SUPPORTED AND REINFORCED AT THE CORRECT CLEARANCES BY THE USE OF BAR CHAIRS OR OTHER APPROVED SUPPORT.
9. ALL CONDUIT MUST BE PLACED WITH A MINIMUM 4" OF COVER UNLESS OTHERWISE SPECIFIED.
10. ALL BACKFILLING WILL BE MECHANICALLY TAMPED IN LIFTS TO A DENSITY OF 95% PROCTOR THE REQUIRED DENSITY WILL BE OBTAINED BY USING TAMPERERS, ROLLERS OR ROLLING EQUIPMENT. LIFTS MAY VARY ACCORDING TO THE TYPE OF EQUIPMENT USED TO OBTAIN THE REQUIRED DENSITY. SAND AND DENNIS FREE MATERIAL WILL BE USED FOR BACKFILL.

PID 3291437  
County road crossings on CR 3133



Legend  
Aerial Cable  
Down Guy

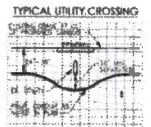

UNDERGROUND CONDUIT 1-2" HDPE

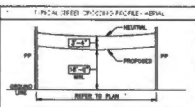

PREPARED BY: DFW TELECOM, INC

17,238 (5)

# Spectrum

1565 Chenault Street, Dallas, Texas 75228

January 12, 2022

Office of County Commissioners  
PO BOX 1097  
Greenville, Texas 75403

FILED FOR RECORD  
at 1:30 o'clock P M

JAN 25 2022

BECKY LANDRUM  
County Clerk, Hunt County, Tex.  
By [Signature]

**Aerial and / or Underground Crossing(s)  
Project PID 3248354**

Greetings,

Spectrum/Charter is requesting permission to construct and placement of fiber which may consist of both underground and aerial attachment to existing poles. This request is for multiple road crossings on county road 3308, which is located in Greenville, Hunt County, Texas.

Site location map and google plans are enclosed. The construction plans detail the proposed work. All road crossings will have a minimum vertical clearance of 18 feet.

If you have any questions, please contact me at any time.

Sincerely,

*Jason Kennedy*  
Project Coordinator  
[Jason.kennedy@charter.com](mailto:Jason.kennedy@charter.com)  
Phone 903-513-2738

Submitted by:  
Dayna LaPoma / Jessie Hatley  
Project Coordinator / RDOF Coordinator  
[Dayna.lapoma@dfw-telecom.com](mailto:Dayna.lapoma@dfw-telecom.com)  
[Jessie.hatley@dfw-telecom.com](mailto:Jessie.hatley@dfw-telecom.com)

Enclosures

---

County Approval Section:

Approved: ✓ Denied: \_\_\_\_\_

Authorized Signature: [Signature] Date: 1-25-22



# Spectrum

**NOTE**  
CONTRACTOR IS RESPONSIBLE TO MAINTAIN TRAFFIC CONTROL AS SET FORTH IN THE TEXAS MANUAL ON UNIFORM TRAFFIC CONTROL DEVICES FOR STREETS AND HIGHWAYS

Hunt County Road Crossings

Project consists of approximately:  
7 aerial crossings: 94', 273', 55', 57', 145', 78', 106'  
5 underground crossings: 53', 78', 120', 53', 12'

### GENERAL CONSTRUCTION NOTES

1. ALL CONSTRUCTION WORK WITHIN THE PUBLIC RIGHT-OF-WAY SHALL BE DONE IN ACCORDANCE WITH THE ORDINANCES AND REGULATIONS OF THE MUNICIPALITY IN WHICH THE WORK IS TO BE PERFORMED.
2. CERTAIN SURVEY CONTROL POINTS ARE SHOWN FROM AVAILABLE RECORDS AND MAY NOT BE ALL INCLUDING. SURVEY LOCATIONS ARE GENERALLY SHOWN TO REFLECT THE SIZE AND LOCATION OF EACH PARTICULAR POINT. THE CONSTRUCTION CONTRACTOR SHALL ASSUME RESPONSIBILITY FOR ACTUAL LINE LOCATED IN THE FIELD AND THE PROTECTION OF ALL EXISTING FACILITIES WHETHER SHOWN OR NOT. THE CONSTRUCTION CONTRACTOR SHALL ALSO ASSUME RESPONSIBILITY FOR REPAIRS TO ANY EXISTING FACILITY DAMAGED AS A DIRECT RESULT OF THE CONSTRUCTION ACTIVITIES WHETHER THE FACILITY IS SHOWN ON THE DRAWINGS OR NOT.
3. THE CONSTRUCTION CONTRACTOR SHALL BE RESPONSIBLE FOR CONDUCTING ALL DETERMINATIONS WITHIN THE MUNICIPALITY AND THE ADJACENT JURISDICTIONS AT LEAST TWO HOURS BEFORE WORK TO THE COMMENCEMENT OF WORK. CALL BEFORE YOU DIG. IT'S THE LAW.
4. IT SHALL BE THE RESPONSIBILITY OF THE CONSTRUCTION CONTRACTOR TO PROVIDE SHIELDING TO PROTECT AND MAINTAIN PUBLIC PROPERTY. IT IS THE RESPONSIBILITY OF THE CONSTRUCTION CONTRACTOR TO OBTAIN A BETTER CONTRACT.
5. SHIELDING AND TRAFFIC CONTROL SHALL BE THE RESPONSIBILITY OF THE CONSTRUCTION CONTRACTOR AND SHALL CONFORM TO THE "TEXAS MANUAL ON UNIFORM TRAFFIC CONTROL DEVICES" TRAFFIC FLOW AND ACCESS SHALL BE MAINTAINED DURING ALL PHASES OF CONSTRUCTION. THE CONSTRUCTION CONTRACTOR IS RESPONSIBLE FOR PROVIDING TRAFFIC SAFETY MEASURES FOR WORK ON THE PROJECT. THE WORK SITE SHALL BE SAFELY LIT AND SHIELDED AS NECESSARY.
6. THE CONSTRUCTION CONTRACTOR SHALL ABIDE BY ALL APPLICABLE FEDERAL, STATE AND LOCAL LAWS CONCERNING LOCATION. THE CONSTRUCTION CONTRACTOR SHALL PROVIDE ALL NECESSARY SAFETY MEASURES THAT COMPLY WITH ALL LAWS GOVERNING LOCATION. THE CONSTRUCTION CONTRACTOR SHALL BE SOLELY RESPONSIBLE FOR ALL ASPECTS OF WORK RELATED TO LOCATION.
7. ALL CONCRETE USED IN ANY ROADWAY SHALL BE IN COMPLIANCE WITH THE SPECIFIED CLASS OF CONCRETE IN THE STANDARD SPECIFICATIONS S.B. "PORTLAND CEMENT CONCRETE FINISHMENT" AND 7-A.3 "QUALITY OF CONCRETE" AS ADVISED BY THE OBSERVER TO THE ADJUTANT GENERAL. THE CONSTRUCTION CONTRACTOR SHALL BE SOLELY RESPONSIBLE FOR ALL ASPECTS OF WORK RELATED TO LOCATION.
8. ALL REINFORCING STEEL AND CONCRETE SHALL BE INSTALLED AND FINISHED AT THE CORRECT CLEARANCES BY THE USE OF SUE CHAINS OR OTHER APPROVED SUPPORT.
9. ALL CONDUIT MUST BE PLACED WITH A MINIMUM 4" OF COVER, UNLESS OTHERWISE SPECIFIED.
10. ALL BENCHMANS WILL BE MECHANICALLY SHIPPED IN LIFTS TO A SECURITY OF USE PROCTOR. THE REQUIRED SECURITY WILL BE OBTAINED BY USING TRUCKS, WAGONS OR ROLLING CRANES. LIFTS MUST BE USED ACCORDING TO THE TYPE OF EQUIPMENT USED TO OBTAIN THE REQUIRED SECURITY. SAND AND BAGGING PRICE MATERIAL WILL BE USED FOR BENCHMANS.

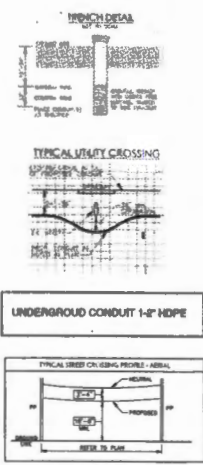

PREPARED BY: DFW TELECOM, INC



17,238 (4)



1565 Chenault Street, Dallas, Texas 75228

January 12, 2022

Office of County Commissioners  
PO BOX 1097  
Greenville, Texas 75403

FILED FOR RECORD  
at 1:30 o'clock P M

JAN 25 2022

BECKY LANDRUM  
County Clerk, Hunt County, Tex.  
By

**Aerial and / or Underground Crossing(s)  
Project PID 3248354**

Greetings,

Spectrum/Charter is requesting permission to construct and placement of fiber which may consist of both underground and aerial attachment to existing poles. This request is for multiple road crossings on county road 3318, which is located in Greenville, Hunt County, Texas.

Site location map and google plans are enclosed. The construction plans detail the proposed work. All road crossings will have a minimum vertical clearance of 18 feet.

If you have any questions, please contact me at any time.

Sincerely,

*Jason Kennedy*  
Project Coordinator  
[Jason.kennedy@charter.com](mailto:Jason.kennedy@charter.com)  
Phone 903-513-2738

Submitted by:  
Dayna LaPoma / Jessie Hatley  
Project Coordinator / RDOF Coordinator  
[Dayna.lapoma@dfw-telecom.com](mailto:Dayna.lapoma@dfw-telecom.com)  
[Jessie.hatley@dfw-telecom.com](mailto:Jessie.hatley@dfw-telecom.com)

Enclosures

County Approval Section:

Approved: \_\_\_\_\_ Denied: \_\_\_\_\_

Authorized Signature: Date: 1-25-22

# Spectrum

NOTE:  
CONTRACTOR IS RESPONSIBLE TO MAINTAIN TRAFFIC CONTROL  
AS SET FORTH IN THE TEXAS MANUAL ON UNIFORM TRAFFIC  
CONTROL DEVICES FOR STREETS AND HIGHWAYS

Hunt County Road Crossings

Project consists of approximately:  
1 aerial crossings:  
110'

### GENERAL CONSTRUCTION NOTES

1. ALL CONSTRUCTION WORK WITHIN THE PUBLIC RIGHT-OF-WAY SHALL BE DONE IN ACCORDANCE WITH THE ORDINANCES AND REGULATIONS OF THE MUNICIPALITY IN WHICH THE WORK IS TO BE PERFORMED.
2. EXISTING UTILITY LOCATIONS SHOWN ARE BASED FROM AVAILABLE RECORDS AND MAY NOT BE ALL INCLUDING. UTILITY LOCATIONS THE CONTRACTOR SHALL VERIFY AND SHALL BE RESPONSIBLE FOR THE SIZE AND LOCATION OF EACH PARTICULAR UTILITY. THE CONSTRUCTION CONTRACTOR SHALL ASSUME RESPONSIBILITY FOR VERIFYING THE LOCATION OF ALL UTILITIES AND THE PROTECTION OF ALL UTILITIES EXPOSED BY OR AS A RESULT OF THE CONSTRUCTION WORK. THE CONSTRUCTION CONTRACTOR SHALL BE SOLELY RESPONSIBLE FOR ALL ASPECTS OF WORK RELATED TO EXPOSURE.
3. THE CONSTRUCTION CONTRACTOR SHALL BE RESPONSIBLE FOR CONDUCTING ALL SURVEYS WITHIN THE MUNICIPALITY AND THE UTILITY COMPANIES AT LEAST TWO WEEKS PRIOR TO THE COMMENCEMENT OF WORK.  
CALL BEFORE YOU DIG  
811  
IT'S THE LAW
4. IT SHALL BE THE RESPONSIBILITY OF THE CONSTRUCTION CONTRACTOR TO A) PREVENT DAMAGE TO PRIVATE AND PUBLIC PROPERTY; B) REMOVE ALL DEBRIS EFFECTED BY THE CONSTRUCTION TO ORIGINAL OR BETTER CONDITION.
5. SIGNAGE AND TRAFFIC CONTROL SHALL BE THE RESPONSIBILITY OF THE CONSTRUCTION CONTRACTOR AND SHALL CONFORM TO THE TEXAS MANUAL ON UNIFORM TRAFFIC CONTROL DEVICES. TRAFFIC FLOW AND ACCESS SHALL BE MAINTAINED DURING ALL PHASES OF CONSTRUCTION. THE CONSTRUCTION CONTRACTOR IS RESPONSIBLE FOR PROVIDING TRAFFIC SAFETY MEASURES FOR WORK ON THE PROJECT. THE WORK SITE SHALL BE SURVEYED AND BRIDGES AT WORK.
6. THE CONSTRUCTION CONTRACTOR SHALL ABIDE BY ALL APPLICABLE FEDERAL, STATE AND LOCAL LAWS GOVERNING EXCAVATION. THE CONSTRUCTION CONTRACTOR SHALL PROVIDE ALL FRENCH DRILLS PERFORMED THAT COMPLY WITH ALL LAWS GOVERNING EXCAVATION. THE CONSTRUCTION CONTRACTOR SHALL BE SOLELY RESPONSIBLE FOR ALL ASPECTS OF WORK RELATED TO EXCAVATION.
7. ALL CONCRETE USED IN ANY ROADWAY SHALL BE IN COMPLIANCE WITH THE SPECIFIED CLASS OF CONCRETE IN THE STANDARD SPECIFICATIONS FOR PORTLAND CEMENT CONCRETE ROADWAY AND T&E "MANUAL OF CONCRETE" AS AMENDED BY THE AMERICAN ROAD & BUILDING BUILDERS ASSOCIATION. ALL CONCRETE SHALL BE CURED & PROTECTED.
8. ALL REINFORCING STEEL AND BARS IN PAVEMENT SHALL BE SUPPORTED AND MAINTAINED AT THE CORRECT CLEARANCES BY THE USE OF BAR CHAIRS OR OTHER APPROVED SUPPORT.
9. ALL CONCRETE MUST BE PLACED WITH A MINIMUM 4" OF CONCRETE UNLESS OTHERWISE SPECIFIED.
10. ALL SHOULDER SHALL BE NEARLYLY FINISHED IN LOTS TO A GRADIENT OF ONE PERCENT. THE FINISHED SURFACE SHALL BE COMPACTED BY USING IMPROPER NUMBER OF ROLLING EQUIPMENT. LOTS MAY VARY ACCORDING TO THE TYPE OF EQUIPMENT USED TO OBTAIN THE REQUIRED DENSITY. SAND AND SOILING FREE MATERIAL SHALL BE USED FOR SHOULDER.

PID 3248354  
County Road Crossings on CR 3318



### Legend

- Aerial Cable
- Down Guy
- Underground

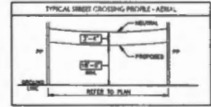
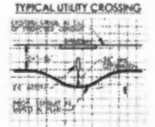

PREPARED BY: DFW TELECOM, INC

17,238 (7)

# Spectrum

1565 Chenault Street, Dallas, Texas 75228

January 19, 2022

Office of County Commissioners  
PO BOX 1097  
Greenville, Texas 75403

FILED FOR RECORD  
at 1:30 o'clock P M

JAN 25 2022

BECKY LANDRUM  
County Clerk, Hunt County, Tex.  
By 

**Aerial and / or Underground Crossing(s)  
Project PID 3291437**

Greetings,

Spectrum/Charter is requesting permission to construct and placement of fiber which may consist of both underground and aerial attachment to existing poles. This request is for multiple road crossings on county road 3402 which is located in Lone Oak, Hunt County, Texas.

Site location map and google plans are enclosed. The construction plans detail the proposed work. All road crossings will have a minimum vertical clearance of 18 feet.

If you have any questions, please contact me at any time.

Sincerely,

*Jason Kennedy*  
Project Coordinator  
[Jason.kennedy@charter.com](mailto:Jason.kennedy@charter.com)  
Phone 903-513-2738

Submitted by:  
Dayna LaPoma / Jessie Hatley  
Project Coordinator / RDOF Coordinator  
[Dayna.lapoma@dfw-telecom.com](mailto:Dayna.lapoma@dfw-telecom.com)  
[jessie.hatley@dfw-telecom.com](mailto:jessie.hatley@dfw-telecom.com)

Enclosures

---

County Approval Section:

Approved: \_\_\_\_\_ Denied: \_\_\_\_\_

Authorized Signature:  \_\_\_\_\_ Date: 1-25-22

# Spectrum

NOTE  
CONTRACTOR IS RESPONSIBLE TO MAINTAIN TRAFFIC CONTROL,  
AS SET FORTH IN THE TEXAS MANUAL ON UNIFORM TRAFFIC  
CONTROL DEVICES FOR STREETS AND HIGHWAYS

Hunt County Road Crossing

Project consist of approximately:  
1 aerial crossings:  
258'

**GENERAL CONSTRUCTION NOTES**

1. ALL CONSTRUCTION WORK WITHIN THE PUBLIC RIGHT-OF-WAY SHALL BE DONE IN ACCORDANCE WITH THE SPECIFICATIONS AND REQUIREMENTS OF THE HIGHWAY DEPARTMENT OF TEXAS.
2. EXISTING UTILITY LOCATIONS SHOWN ARE BASED ON AVAILABLE RECORDS AND MAY NOT BE ALL INCLUDING. UTILITY LOCATIONS ARE GENERALLY SHOWN IN RED AND MAY NOT ACCURATELY REFLECT THE TRUE AND EXACT LOCATION OF SUCH UTILITIES. THE CONSTRUCTION CONTRACTOR SHALL VERIFY THE LOCATION OF ALL UTILITIES BY FIELD AND THE PROVISIONS OF ALL APPLICABLE FEDERAL, STATE AND LOCAL LAWS, ORDINANCES AND REGULATIONS. THE CONSTRUCTION CONTRACTOR SHALL BE RESPONSIBLE FOR ANY DAMAGE TO ANY UTILITIES CAUSED BY THE CONSTRUCTION CONTRACTOR'S NEGLIGENCE OR CARELESSNESS.
3. THE CONSTRUCTION CONTRACTOR SHALL BE RESPONSIBLE FOR OBTAINING ALL NECESSARY PERMITS FROM THE HIGHWAY DEPARTMENT AND THE UTILITY COMPANIES AT LEAST 90 DAYS PRIOR TO THE COMMENCEMENT OF WORK. CALL BEFORE YOU DIG 811 IS THE LAW.
4. IT SHALL BE THE RESPONSIBILITY OF THE CONSTRUCTION CONTRACTOR TO PROVIDE SUFFICIENT TRAFFIC AND PUBLIC PROTECTION, AS REQUIRED BY ALL APPLICABLE SPECIFICATIONS, ORDINANCES, AND REGULATIONS.
5. BARRICADES AND TRAFFIC CONTROL SHALL BE THE RESPONSIBILITY OF THE CONSTRUCTION CONTRACTOR AND SHALL CONFORM TO THE "MUTUAL AID UNIFORM TRAFFIC CONTROL DEVICES" MANUAL AND ACCESS SHALL BE MAINTAINED THROUGHOUT THE PROJECT. THE CONSTRUCTION CONTRACTOR IS RESPONSIBLE FOR PROVIDING TRAFFIC SAFETY FOR WORK ON THE PROJECT. THE RIGHT OF WAY SHALL BE SUFFICIENTLY AND UNINTERRUPTEDLY KEPT.
6. THE CONSTRUCTION CONTRACTOR SHALL ABIDE BY ALL APPLICABLE FEDERAL, STATE AND LOCAL LAWS, ORDINANCES, REGULATIONS, AND REQUIREMENTS. THE CONSTRUCTION CONTRACTOR SHALL MAINTAIN ALL TRAFFIC SAFETY THROUGHOUT THE PROJECT FOR ALL ASPECTS OF WORK RELATED TO CONSTRUCTION.
7. ALL CONCRETE USED IN ANY ROADWAY SHALL BE IN COMPLIANCE WITH THE SPECIFIED CLASS OF CONCRETE IN THE SPECIFICATIONS AND SHALL BE PROVED TO BE OF THE QUALITY AND STRENGTH AS REQUIRED BY THE SPECIFICATIONS TO THE ROADWAY. ALL CONCRETE SHALL BE CLASS A CONCRETE.
8. ALL REINFORCING STEEL AND WIRE ROPE SHALL BE PROVIDED SHALL BE SUPPORTED AND MAINTAINED AT THE CORRECT CLEARANCES BY THE USE OF BAR CHAIRS OR OTHER APPROVED SUPPORT.
9. ALL CONCRETE SHALL BE PLACED WITH A MINIMUM 4" OF COVER, UNLESS OTHERWISE SPECIFIED.
10. ALL STRUCTURES SHALL BE PROTECTED BY A SERIES OF 4" DIA. PILES. THE REQUIRED CLEARANCE SHALL BE MAINTAINED BY USING TRAFFIC BARRICADES OR OTHER SAFETY DEVICES. ALL TRAFFIC BARRICADES SHALL BE USED TO MAINTAIN THE REQUIRED CLEARANCE TO THE STRUCTURE. SAND AND GRAVEL FILL MATERIAL SHALL BE USED FOR SHOULDER.

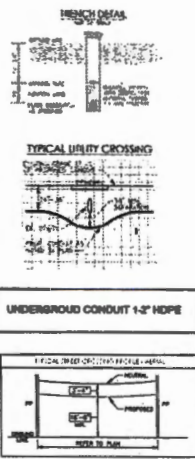
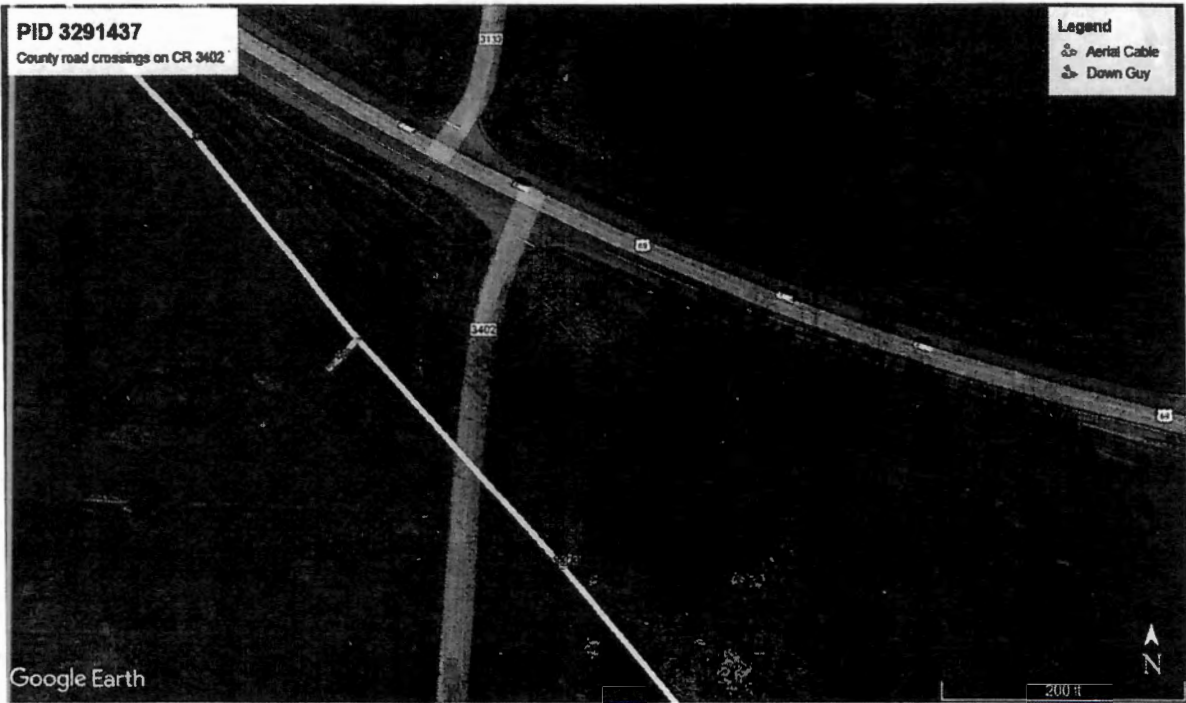

PREPARED BY: DFW TELECOM, INC



17,238 (8)

# Spectrum

1565 Chenault Street, Dallas, Texas 75228

January 19, 2022

Office of County Commissioners  
PO BOX 1097  
Greenville, Texas 75403

FILED FOR RECORD  
at 1:30 o'clock P M

JAN 25 2022

BECKY LANDRUM  
County Clerk, Hunt County, Tex.  
By 

**Aerial and / or Underground Crossing(s)  
Project PID 3291437**

Greetings,

Spectrum/Charter is requesting permission to construct and placement of fiber which may consist of both underground and aerial attachment to existing poles. This request is for multiple road crossings on county road 3403 which is located in Lone Oak, Hunt County, Texas.

Site location map and google plans are enclosed. The construction plans detail the proposed work. All road crossings will have a minimum vertical clearance of 18 feet.

If you have any questions, please contact me at any time.

Sincerely,

*Jason Kennedy*  
Project Coordinator  
[Jason.kennedy@charter.com](mailto:Jason.kennedy@charter.com)  
Phone 903-513-2738

Submitted by:  
Dayna LaPoma / Jessie Hatley  
Project Coordinator / RDOF Coordinator  
[Dayna.lapoma@dfw-telecom.com](mailto:Dayna.lapoma@dfw-telecom.com)  
[Jessie.hatley@dfw-telecom.com](mailto:Jessie.hatley@dfw-telecom.com)

Enclosures

County Approval Section: ✓

Approved: \_\_\_\_\_ Denied: \_\_\_\_\_

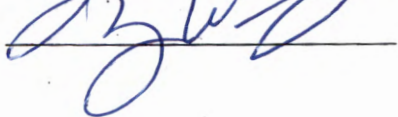
Authorized Signature:  \_\_\_\_\_ Date: 1-25-22



# Spectrum

NOTE  
CONTRACTOR IS RESPONSIBLE TO MAINTAIN TRAFFIC CONTROL,  
AS SET FORTH IN THE TEXAS MANUAL ON UNIFORM TRAFFIC  
CONTROL DEVICES FOR STREETS AND HIGHWAYS

Hunt County Road Crossing

Project consist of approximately:  
3 aerial crossings:  
244'  
70'  
166'

**GENERAL CONSTRUCTION NOTES**

1. ALL OBSTRUCTIONS ABOVE THE PUBLIC RIGHT-OF-WAY SHALL BE REMOVED IN ACCORDANCE WITH THE ORDINANCES AND REGULATIONS OF THE JURISDICTION IN WHICH THE WORK IS TO BE PERFORMED.
2. EXISTING UTILITY LOCATIONS SHOWN ARE BASED FROM AVAILABLE RECORDS AND MAY NOT BE ALL INCLUDING, BUT NOT LIMITED TO, THE GENERALLY LOCATED IN RECORDS AND ARE NOT NECESSARILY THE SIZE AND LOCATION OF SUCH UTILITIES. THE CONSTRUCTION CONTRACTOR SHALL MAINTAIN RESPONSIBILITY FOR ACTUAL LINE LOCATIONS IN THE FIELD AND THE PROTECTION OF ALL EXISTING UTILITIES WHETHER KNOWN OR NOT. THE CONSTRUCTION CONTRACTOR SHALL ASSUME RESPONSIBILITY FOR REMOVAL OF ANY EXISTING FACILITY DAMAGED AS A DIRECT RESULT OF THE CONSTRUCTION WORKER UNLESS THE FACILITY IS SHOWN ON THE RECORDS AS NOT.
3. THE CONSTRUCTION CONTRACTOR SHALL BE RESPONSIBLE FOR OBTAINING ALL PERMITS WITHIN THE JURISDICTION AND THE LOCAL JURISDICTION OF LAND TO BE USED FOR THE CONSTRUCTION OF WORK.  
CALL BEFORE YOU DIG  
811  
IT'S THE LAW
4. IT SHALL BE THE RESPONSIBILITY OF THE CONSTRUCTION CONTRACTOR TO OBTAIN ALL NECESSARY PERMITS AND PUBLIC PROPERTY, TO REMOVE ALL OBSTRUCTIONS TO THE CONSTRUCTION OF WORK, OR REMOVE OBSTRUCTIONS.
5. SIGNAGING AND TRAFFIC CONTROL SHALL BE THE RESPONSIBILITY OF THE CONSTRUCTION CONTRACTOR AND SHALL CONFORM TO THE "TEXAS MANUAL ON UNIFORM TRAFFIC CONTROL DEVICES", TRAFFIC FLOW AND ACCESS SHALL BE MAINTAINED THROUGHOUT THE COURSE OF CONSTRUCTION. THE CONSTRUCTION CONTRACTOR IS RESPONSIBLE FOR PROVIDING TRAFFIC SAFETY SIGNALS FOR WORK ON THE PROJECT. THE ROAD SIDE SHALL BE SAFELY LIT AND UNOCCUPIED AT NIGHT.
6. THE CONSTRUCTION CONTRACTOR SHALL ABIDE BY ALL APPLICABLE FEDERAL, STATE AND LOCAL LAWS GOVERNING CONSTRUCTION. THE CONSTRUCTION CONTRACTOR SHALL MAINTAIN ALL NECESSARY SAFETY THROUGHOUT THE COURSE OF ALL WORK. CONSTRUCTION OF THE CONSTRUCTION CONTRACTOR SHALL BE FULLY RESPONSIBLE FOR ALL ASPECTS OF WORK RELATED TO CONSTRUCTION.
7. ALL CONCRETE USED IN ANY STRUCTURE SHALL BE IN COMPLIANCE WITH THE SPECIFIED CLASS OF CONCRETE IN THE DRAWING SPECIFICATIONS & "PORTLAND CEMENT CONCRETE FINISHES" AND "AS-BUILT" QUALITY OF CONCRETE" AS APPROVED BY THE CONTRACTOR TO THE BEST OF HIS KNOWLEDGE. THE CONSTRUCTION CONTRACTOR SHALL BE FULLY RESPONSIBLE FOR ALL ASPECTS OF WORK RELATED TO CONSTRUCTION.
8. ALL REINFORCING BARS AND BUNDLES IN REINFORCEMENT SHALL BE SUPPORTED AND MAINTAINED AT THE CORRECT CLEARANCES BY THE USE OF BAR CHAIRS OR OTHER APPROVED EQUIPMENT.
9. ALL CONCRETE SHALL BE PLACED WITH A MINIMUM 4" OF COVER, UNLESS OTHERWISE SPECIFIED.
10. ALL REINFORCING SHALL BE MECHANICALLY TIED IN LEFTS TO A DENSITY OF ONE PROCTOR. THE REQUIRED DENSITY SHALL BE OBTAINED BY USING TYPICAL METHODS OR BALLING COMPACTOR. LEFTS MAY BE MADE ACCORDING TO THE TYPE OF EQUIPMENT USED TO OBTAIN THE REQUIRED DENSITY. SAND AND GRADE FILL MATERIALS SHALL BE USED FOR BACKFILL.

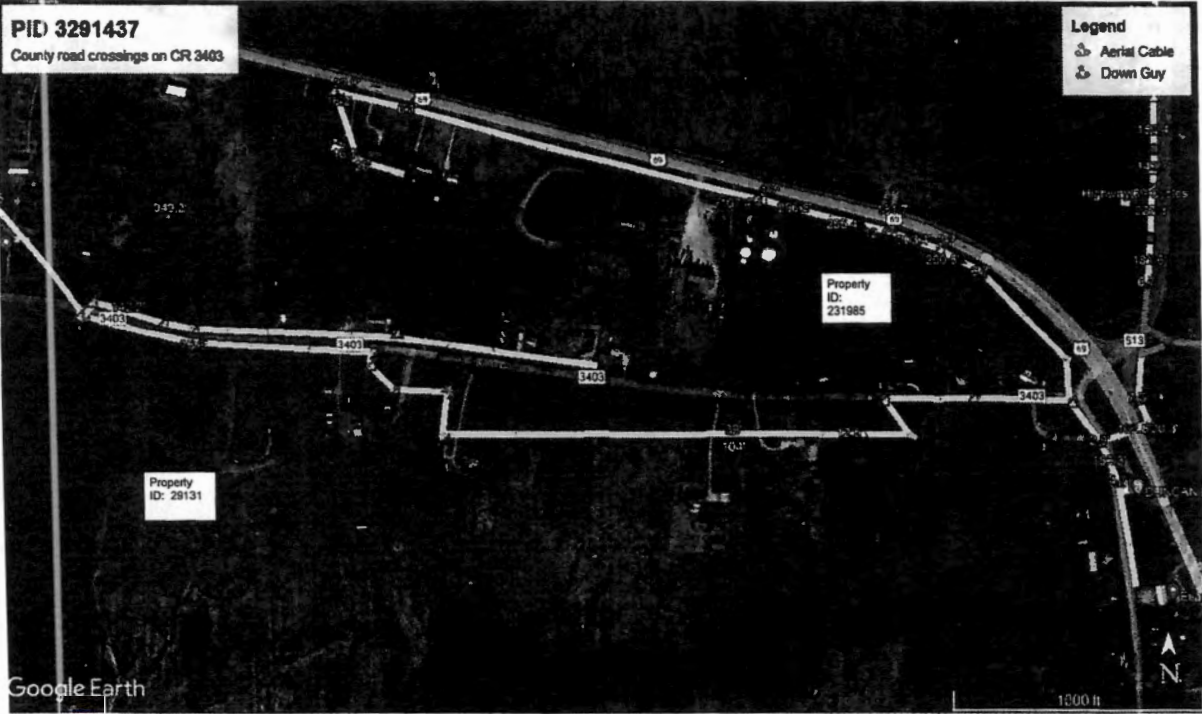

**Legend**  
 Aerial Cable  
 Down Guy

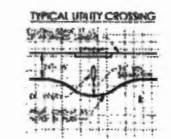
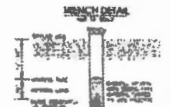

UNDERGROUND CONDUIT 1-2" HDPE

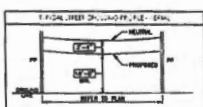

PREPARED BY: DFW TELECOM, INC

17,238 (9)



1565 Chenault Street, Dallas, Texas 75228

January 12, 2022

Office of County Commissioners  
PO BOX 1097  
Greenville, Texas 75403

FILED FOR RECORD  
at 1:30 o'clock P M

JAN 25 2022

BECKY LANDRUM  
County Clerk, Hunt County, Tex.  
By

**Aerial and / or Underground Crossing(s)  
Project PID 3248354**

Greetings,

Spectrum/Charter is requesting permission to construct and placement of fiber which may consist of both underground and aerial attachment to existing poles. This request is for multiple road crossings on county road 3507, which is located in Greenville, Hunt County, Texas.

Site location map and google plans are enclosed. The construction plans detail the proposed work. All road crossings will have a minimum vertical clearance of 18 feet.

If you have any questions, please contact me at any time.

Sincerely,

*Jason Kennedy*  
Project Coordinator  
[Jason.kennedy@charter.com](mailto:Jason.kennedy@charter.com)  
Phone 903-513-2738

Submitted by:  
Dayna LaPoma / Jessie Hatley  
Project Coordinator / RDOF Coordinator  
[Dayna.lapoma@dfw-telecom.com](mailto:Dayna.lapoma@dfw-telecom.com)  
[Jessie.hatley@dfw-telecom.com](mailto:Jessie.hatley@dfw-telecom.com)

Enclosures

County Approval Section:

Approved:  Denied:

Authorized Signature: Date: 1-25-22

# Spectrum

**NOTE**  
CONTRACTOR IS RESPONSIBLE TO MAINTAIN TRAFFIC CONTROL AS SET FORTH IN THE TEXAS MANUAL ON UNIFORM TRAFFIC CONTROL DEVICES FOR STREETS AND HIGHWAYS

Hunt County Road Crossings

Project consists of approximately:  
1 aerial crossings:  
334'

- GENERAL CONSTRUCTION NOTES**
1. ALL CONSTRUCTION WORK WITHIN THE PUBLIC RIGHT-OF-WAY SHALL BE DONE IN ACCORDANCE WITH THE ORDINANCES AND REGULATIONS OF THE JURISDICTION IN WHICH THE WORK IS TO BE PERFORMED.
  2. EXISTING UTILITY LOCATIONS SHOWN ARE BASED UPON AVAILABLE RECORDS AND MAY NOT BE FULLY ACCURATE. UTILITY LOCATIONS ARE GENERALLY INDICATED BY SYMBOLS AND MAY NOT ACCURATELY REFLECT THE SIZE AND LOCATION OF EACH PARTICULAR UTILITY. THE CONSTRUCTION CONTRACTOR SHALL ASSUME RESPONSIBILITY FOR ACTUAL LINE LOCATIONS IN THE FIELD AND THE PROTECTION OF ALL EXISTING UNIDENTIFIED UTILITIES SHOWN OR NOT. THE CONSTRUCTION CONTRACTOR SHALL ALSO ASSUME RESPONSIBILITY FOR ADHERING TO ANY EXISTING FACILITY AGREEMENTS AS A DIRECT RESULT OF THE CONSTRUCTION ACTIVITIES WHETHER THE FACILITY IS SHOWN ON THE DRAWINGS OR NOT.
  3. THE CONSTRUCTION CONTRACTOR SHALL BE RESPONSIBLE FOR CONTACTING ALL NEIGHBORS WITHIN THE WADSWORTH AND THE VULPIY CORPACED AT LEAST TWO WEEKS PRIOR TO THE COMMENCEMENT OF WORK.  
**CALL BEFORE YOU DIG**  
811  
**IT'S THE LAW**
  4. IT SHALL BE THE RESPONSIBILITY OF THE CONSTRUCTION CONTRACTOR TO AS PREVIOUS SHOWN TO PRIVATE AND PUBLIC NEIGHBORS TO RESOLVE ALL AREAS AFFECTED BY THE CONSTRUCTION TO ORIGINAL OR BETTER CONDITION.
  5. SHORINGS AND BRUTE CONTROL SHALL BE THE RESPONSIBILITY OF THE CONSTRUCTION CONTRACTOR AND SHALL CONFORM TO THE TEXAS MANUAL ON UNIFORM TRAFFIC CONTROL DEVICES. TRAFFIC FLUES AND ACCESS SHALL BE MAINTAINED THROUGHOUT ALL PHASES OF CONSTRUCTION. THE CONSTRUCTION CONTRACTOR IS RESPONSIBLE FOR PROVIDING TRAFFIC SAFETY MEASURES FOR WORK ON THE PROJECT. THE WORK SITE SHALL BE SAFELY LIT AND BARRICADED AS NECESSARY.
  6. THE CONSTRUCTION CONTRACTOR SHALL ABIDE BY ALL APPLICABLE FEDERAL, STATE AND LOCAL LAWS GOVERNING CONSTRUCTION. THE CONSTRUCTION CONTRACTOR SHALL PROVIDE ALL TRAFFIC SAFETY DEVICES THAT COMPLY WITH ALL LAWS GOVERNING CONSTRUCTION. THE CONSTRUCTION CONTRACTOR SHALL BE SOLELY RESPONSIBLE FOR ALL ASPECTS OF WORK RELATED TO CONSTRUCTION.
  7. ALL CONCRETE USED IN ANY ROADWAY SHALL BE IN COMPLIANCE WITH THE SPECIFIED CLASS OF CONCRETE IN THE STANDARD SPECIFICATIONS, S.S. "PORTLAND CEMENT CONCRETE, FINISHED" AND T.A.S. "QUALITY OF CONCRETE" AS INDICATED BY THE ARCHITECT OR THE DESIGN CONTRACTOR. THE CONSTRUCTION CONTRACTOR SHALL BE SOLELY RESPONSIBLE FOR ALL ASPECTS OF CONSTRUCTION - EXCEPT ALL OTHER CONCRETE SHALL BE CLASS A CONCRETE.
  8. ALL REINFORCING STEEL AND ANCHOR BARS IN PAVEMENT SHALL BE SUPPORTED AND MAINTAINED AT THE CORRECT CLEARANCES BY THE USE OF SPS CHAIRS OR OTHER APPROVED SUPPORTS.
  9. ALL CONDUIT MUST BE PLACED WITH A MINIMUM 4" OF COVER, UNLESS OTHERWISE SPECIFIED.
  10. ALL BACKFILLING WILL BE MECHANICALLY SHIPPED IN LIFTS TO A DENSITY OF 98% PROCTOR. THE REQUIRED DENSITY WILL BE OBTAINED BY USING TAMPERS, ROLLERS OR ROLLING EQUIPMENT. LIFTS MAY VARY ACCORDING TO THE TYPE OF EQUIPMENT USED TO OBTAIN THE REQUIRED DENSITY. SAND AND DEBRIS FREE MATERIAL WILL BE USED FOR BACKFILL.

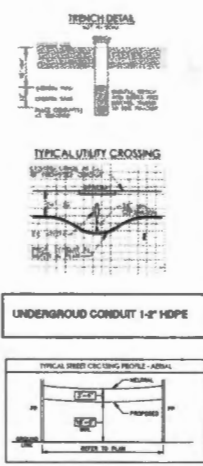
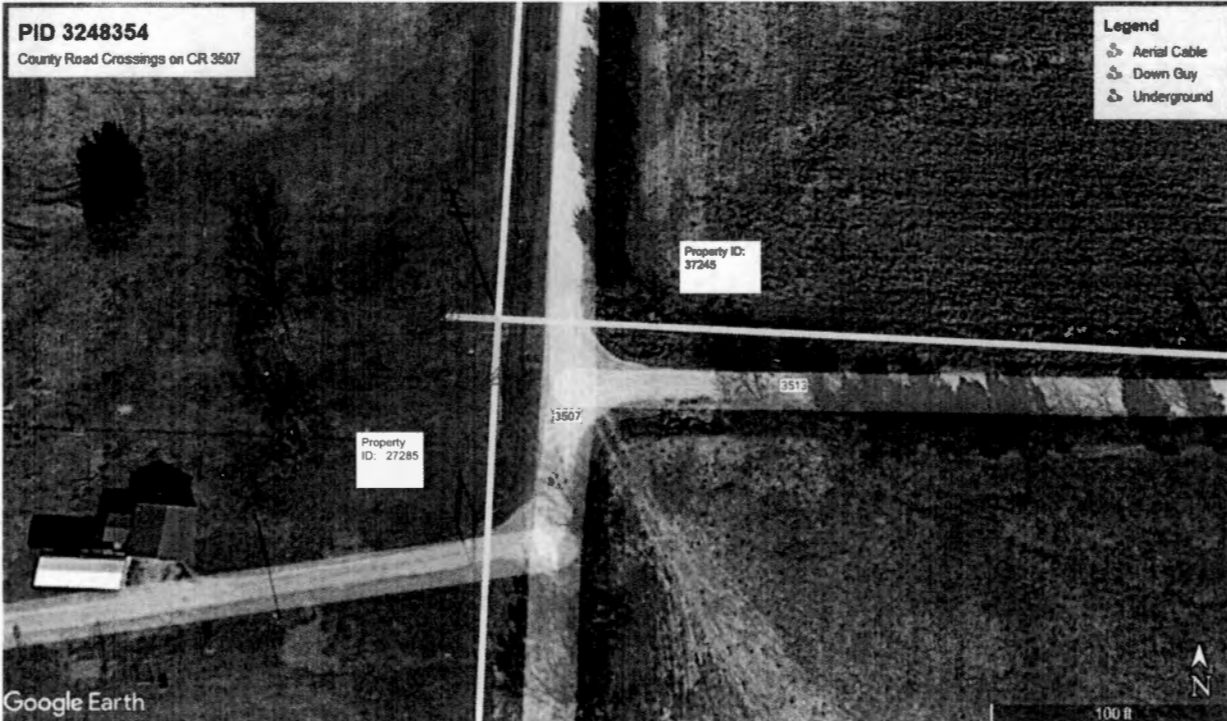

PREPARED BY: DFW TELECOM, INC

17,238 (10)



1565 Chenault Street, Dallas, Texas 75228

January 12, 2022

Office of County Commissioners  
PO BOX 1097  
Greenville, Texas 75403

FILED FOR RECORD  
at 1:30 o'clock P M

JAN 25 2022

**Aerial and / or Underground Crossing(s)  
Project PID 3248354**

BECKY LANDRUM  
County Clerk, Hunt County, Tex.  
By 

Greetings,

Spectrum/Charter is requesting permission to construct and placement of fiber which may consist of both underground and aerial attachment to existing poles. This request is for multiple road crossings on county road 3513, which is located in Greenville, Hunt County, Texas.

Site location map and google plans are enclosed. The construction plans detail the proposed work. All road crossings will have a minimum vertical clearance of 18 feet.

If you have any questions, please contact me at any time.

Sincerely,

*Jason Kennedy*  
Project Coordinator  
[Jason.kennedy@charter.com](mailto:Jason.kennedy@charter.com)  
Phone 903-513-2738

Submitted by:  
Dayna LaPoma / Jessie Hatley  
Project Coordinator / RDOF Coordinator  
[Dayna.lapoma@dfw-telecom.com](mailto:Dayna.lapoma@dfw-telecom.com)  
[Jessie.hatley@dfw-telecom.com](mailto:Jessie.hatley@dfw-telecom.com)

Enclosures

---

County Approval Section:

Approved: ✓ Denied: \_\_\_\_\_  
Authorized Signature:  Date: 1-25-22



# Spectrum

NOTE  
CONTRACTOR IS RESPONSIBLE TO MAINTAIN TRAFFIC CONTROL AS SET FORTH IN THE TEXAS MANUAL ON UNIFORM TRAFFIC CONTROL DEVICES FOR STREETS AND HIGHWAYS

Hunt County Road Crossings

Project consists of approximately:  
1 aerial crossings:  
228'

- GENERAL CONSTRUCTION NOTES**
1. ALL CONSTRUCTION WORK WITHIN THE PUBLIC RIGHT-OF-WAY SHALL BE DONE IN ACCORDANCE WITH THE ORDINANCES AND REGULATIONS OF THE MUNICIPALITY IN WHICH THE WORK IS TO BE PERFORMED.
  2. EXISTING UTILITY LOCATIONS SHOWN ARE BASED FROM AVAILABLE RECORDS AND MAY NOT BE ALL LOCATIONS. UTILITY LOCATIONS ARE GENERALLY SHOWN ON RECORDS AND MAY NOT ACCURATELY REFLECT THE SIZE AND DEPTH OF EACH PARTICULAR UTILITY. THE CONSTRUCTION CONTRACTOR SHALL ASSUME RESPONSIBILITY FOR VERIFYING THE LOCATION AND DEPTH OF ALL UTILITIES LOCATED IN THE FIELD AND THE PROTECTION OF ALL UTILITIES LOCATED THEREIN OR NOT. THE CONSTRUCTION CONTRACTOR SHALL ALSO ASSUME RESPONSIBILITY FOR REMEDY TO ANY DAMAGE INCURRED AS A DIRECT RESULT OF THE CONSTRUCTION WORKER WHETHER THE FACILITY IS SHOWN ON THE RECORDS OR NOT.
  3. THE CONSTRUCTION CONTRACTOR SHALL BE RESPONSIBLE FOR CONTACTING ALL DEPARTMENTS WITHIN THE MUNICIPALITY AND THE UTILITY COMPANIES AT LEAST TWO WORKING DAYS PRIOR TO THE COMMENCEMENT OF WORK. CALL BEFORE YOU DIG IT'S THE LAW.
  4. IT SHALL BE THE RESPONSIBILITY OF THE CONSTRUCTION CONTRACTOR TO: A) PREVENT DAMAGE TO PRIVATE AND PUBLIC PROPERTY; B) REPORT ALL AREAS AFFECTED BY THE CONSTRUCTION TO ORIGINAL OR BETTER CONDITION.
  5. BARRICADES AND TRAFFIC CONTROL SHALL BE THE RESPONSIBILITY OF THE CONSTRUCTION CONTRACTOR AND SHALL CONFORM TO THE TEXAS MANUAL ON UNIFORM TRAFFIC CONTROL DEVICES. TRAFFIC FLOW AND ACCESS SHALL BE MAINTAINED DURING ALL PHASES OF CONSTRUCTION. THE CONSTRUCTION CONTRACTOR IS RESPONSIBLE FOR PROVIDING TRAFFIC SAFETY MEASURES FOR WORK ON THE PROJECT. THE WORK SITE SHALL BE SAFELY LIT AND BARRICADED AT NIGHT.
  6. THE CONSTRUCTION CONTRACTOR SHALL ABIDE BY ALL APPLICABLE FEDERAL, STATE AND LOCAL LAWS GOVERNING EXCAVATION. THE CONSTRUCTION CONTRACTOR SHALL PROVIDE ALL TRAFFIC SAFETY SYSTEMS THAT COMPLY WITH ALL LAWS GOVERNING EXCAVATION. THE CONSTRUCTION CONTRACTOR SHALL BE SOLELY RESPONSIBLE FOR ALL ASPECTS OF WORK RELATED TO EXCAVATION.
  7. ALL CONCRETE USED IN ANY FOOTING SHALL BE IN COMPLIANCE WITH THE SPECIFIED CLASSES OF CONCRETE IN THE STANDARD SPECIFICATIONS 3.5 "PORTLAND CEMENT CONCRETE, FINISHED" AND 7.4.2 "QUALITY OF CONCRETE" AS INDICATED BY THE ADDENDUM TO THE HONEYCREEK TOWNSHIP STANDARD SPECIFICATIONS FOR PUBLIC WORKS CONSTRUCTION - 2004. ALL OTHER CONCRETE SHALL BE CLASS A CONCRETE.
  8. ALL REINFORCING STEEL AND EXCEL BARS IN PAVEMENT SHALL BE SUPPORTED AND UNHARMED AT THE CORRECT CLEARANCES BY THE USE OF BRICK CHAINS OR OTHER APPROVED SUPPORT.
  9. ALL CONCRETE MUST BE PLACED WITH A MINIMUM 4" OF COVER UNLESS OTHERWISE SPECIFIED.
  10. ALL BACKFILLS SHALL BE MECHANICALLY DAMPED IN LIFTS TO A DENSITY OF 95% PROCTOR. THE REQUIRED DENSITY WILL BE OBTAINED BY USING TAMPERS, ROLLERS OR ROLLING EQUIPMENT. LIFTS MAY VARY ACCORDING TO THE TYPE OF EQUIPMENT USED TO OBTAIN THE REQUIRED DENSITY. SAND AND GRADES FREE MATERIALS WILL BE USED FOR BACKFILL.

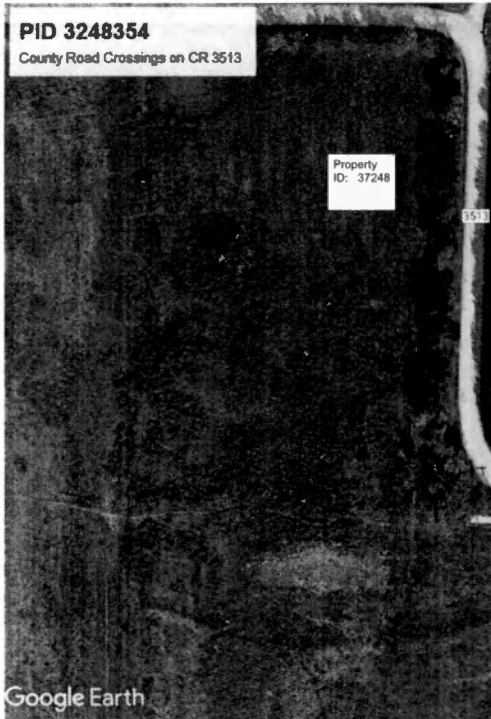

- Legend**
- Aerial Cable
  - Down Guy
  - Underground

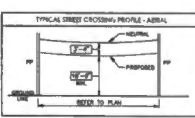
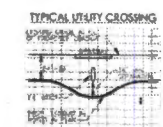

PREPARED BY DFW TELECOM, INC



17,238 (11)



1565 Chenault Street, Dallas, Texas 75228

January 12, 2022

Office of County Commissioners  
PO BOX 1097  
Greenville, Texas 75403

FILED FOR RECORD  
at 1:30 o'clock P M

JAN 25 2022

BECKY LANDRUM  
County Clerk, Hunt County, Tex.  
By

**Aerial and / or Underground Crossing(s)  
Project PID 3248354**

Greetings,

Spectrum/Charter is requesting permission to construct and placement of fiber which may consist of both underground and aerial attachment to existing poles. This request is for multiple road crossings on county road 3520, which is located in Greenville, Hunt County, Texas.

Site location map and google plans are enclosed. The construction plans detail the proposed work. All road crossings will have a minimum vertical clearance of 18 feet.

If you have any questions, please contact me at any time.

Sincerely,

*Jason Kennedy*  
Project Coordinator  
[Jason.kennedy@charter.com](mailto:Jason.kennedy@charter.com)  
Phone 903-513-2738

Submitted by:  
Dayna LaPoma / Jessie Hatley  
Project Coordinator / RDOF Coordinator  
[Dayna.lapoma@dfw-telecom.com](mailto:Dayna.lapoma@dfw-telecom.com)  
[Jessie.hatley@dfw-telecom.com](mailto:Jessie.hatley@dfw-telecom.com)

Enclosures

County Approval Section:

Approved: ✓ Denied: \_\_\_\_\_  
Authorized Signature: Date: 1-25-22

# Spectrum

**NOTE**  
CONTRACTOR IS RESPONSIBLE TO MAINTAIN TRAFFIC CONTROL AS SET FORTH IN THE TEXAS MANUAL ON UNIFORM TRAFFIC CONTROL DEVICES FOR STREETS AND HIGHWAYS

Project consists of approximately:  
2 aerial crossings:  
319'  
50'

Hunt County Road Crossings

### GENERAL CONSTRUCTION NOTES

1. ALL CONSTRUCTION WORK WITHIN THE PUBLIC RIGHT-OF-WAY SHALL BE DONE IN ACCORDANCE WITH THE ORDINANCES AND REGULATIONS OF THE MUNICIPALITY IN WHICH THE WORK IS TO BE PERFORMED.
2. EXISTING UTILITY LOCATIONS SHOWN ARE TAKEN FROM AVAILABLE RECORDS AND MAY NOT BE ALL INCLUDING UTILITY LOCATIONS ARE GENERALLY NOMINALLY IN POSITION AND MAY NOT ACCURATELY REFLECT THE SIZE AND LOCATION OF EACH PARTICULAR UTILITY. THE CONSTRUCTION CONTRACTOR SHALL ASSUME RESPONSIBILITY FOR VERIFYING UTILITY LOCATIONS IN THE FIELD AND THE PROTECTION OF ALL EXISTING UTILITIES WHETHER ABOVE OR BELOW GROUND. THE CONSTRUCTION CONTRACTOR SHALL ALSO ASSUME RESPONSIBILITY FOR REPAIR TO ANY EXISTING FACILITY DAMAGED AS A DIRECT RESULT OF THE CONSTRUCTION ACTIVITIES WHETHER THE FACILITY IS SHOWN ON THE DRAWINGS OR NOT.
3. THE CONSTRUCTION CONTRACTOR SHALL BE RESPONSIBLE FOR OBTAINING ALL NECESSARY PERMITS FROM THE MUNICIPALITY AND THE UTILITY COMPANIES AT LEAST TWO WEEKS BEFORE THE COMMENCEMENT OF WORK. CALL BEFORE YOU DIG 811 IT'S THE LAW.
4. IT SHALL BE THE RESPONSIBILITY OF THE CONSTRUCTION CONTRACTOR TO A) PREVENT DAMAGE TO PRIVATE AND PUBLIC PROPERTY BY RESTORE ALL AREAS DISTURBED BY THE CONSTRUCTION TO ORIGINAL OR BETTER CONDITION.
5. ENCLOSING AND TRAFFIC CONTROL SHALL BE THE RESPONSIBILITY OF THE CONSTRUCTION CONTRACTOR AND SHALL CONFORM TO THE "TEXAS MANUAL ON UNIFORM TRAFFIC CONTROL DEVICES". TRAFFIC FLOW AND ACCESS SHALL BE MAINTAINED DURING ALL PHASES OF CONSTRUCTION. THE CONSTRUCTION CONTRACTOR IS RESPONSIBLE FOR PROVIDING TRAFFIC SAFETY MEASURES FOR WORK ON THE PROJECT. THE WORK SITE SHALL BE SURFACED AND BARBERICED AT NIGHT.
6. THE CONSTRUCTION CONTRACTOR SHALL ABIDE BY ALL APPLICABLE FEDERAL, STATE AND LOCAL LAWS GOVERNING EDUCATION. THE CONSTRUCTION CONTRACTOR SHALL PROVIDE ALL TRAFFIC SAFETY DEVICES THAT COMPLY WITH ALL LAWS GOVERNING EDUCATION. THE CONSTRUCTION CONTRACTOR SHALL BE SOLELY RESPONSIBLE FOR ALL ASPECTS OF WORK RELATED TO EDUCATION.
7. ALL CONCRETE USED IN ANY REPAIRS SHALL BE IN COMPLIANCE WITH THE SPECIFIED CLASS OF CONCRETE IN THE DRAWINGS SPECIFICATIONS IS "PORTLAND CEMENT CONCRETE FINISH" AND 7.5.3 "QUALITY OF CONCRETE" CONTRACTOR - ISM - ALL OTHER CONCRETE SHALL BE CLASS A CONCRETE.
8. ALL REINFORCING STEEL AND TOWER BARS IN MANHOLE'S SHALL BE GALVANIZED AND MAINTAINED AT THE CORRECT CLEARANCES BY THE USE OF BAR CHAIRS OR OTHER APPROVED SUPPORT.
9. ALL CONDUIT MUST BE PLACED WITH A MINIMUM 4" OF COVER, UNLESS OTHERWISE SPECIFIED.
10. ALL MANHOLE'S WILL BE MECHANICALLY RAISED IN LIFTS TO A MINIMUM OF 8 FEET PROCTOR. THE REQUIRED DENSITY WILL BE DETERMINED BY USING TAMPERS, SHIMMERS OR SHIMMERS. LIFTS MUST BE MADE ACCORDING TO THE TYPE OF EQUIPMENT USED TO OBTAIN THE REQUIRED DENSITY. SAND AND GRAIN FREE MATERIAL WILL BE USED FOR BEDDING.

**PID 3248354**  
County Road Crossings on CR 3520



- Legend**
- ⊕ Aerial Cable
  - ⊖ Down Guy
  - ⊕ Overhead Guy
  - ⊕ Underground

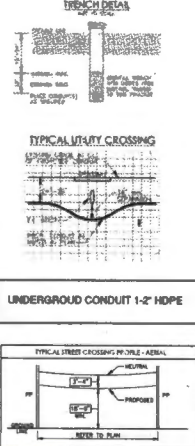

UNDERGROUND CONDUIT 1-2" HDPE

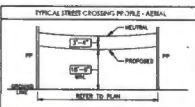

PREPARED BY: DFW TELECOM, INC

17,238 (12)



1565 Chenault Street, Dallas, Texas 75228

January 12, 2022

Office of County Commissioners  
PO BOX 1097  
Greenville, Texas 75403

FILED FOR RECORD  
at 1:30 o'clock P M

JAN 25 2022

BECKY LANDRUM  
County Clerk, Hunt County, Tex.  
By

**Aerial and / or Underground Crossing(s)  
Project PID 3248354**

Greetings,

Spectrum/Charter is requesting permission to construct and placement of fiber which may consist of both underground and aerial attachment to existing poles. This request is for multiple road crossings on county road 3521, which is located in Greenville, Hunt County, Texas.

Site location map and google plans are enclosed. The construction plans detail the proposed work. All road crossings will have a minimum vertical clearance of 18 feet.

If you have any questions, please contact me at any time.

Sincerely,

*Jason Kennedy*  
Project Coordinator  
[Jason.kennedy@charter.com](mailto:Jason.kennedy@charter.com)  
Phone 903-513-2738

Submitted by:  
Dayna LaPoma / Jessie Hatley  
Project Coordinator / RDOF Coordinator  
[Dayna.lapoma@dfw-telecom.com](mailto:Dayna.lapoma@dfw-telecom.com)  
[Jessie.hatley@dfw-telecom.com](mailto:Jessie.hatley@dfw-telecom.com)

Enclosures

County Approval Section:

Approved:  \_\_\_\_\_

Denied: \_\_\_\_\_

Authorized Signature:

Date: 1-25-22



# Spectrum

NOTE:  
CONTRACTOR IS RESPONSIBLE TO MAINTAIN TRAFFIC CONTROL  
AS SET FORTH IN THE TEXAS MANUAL ON UNIFORM TRAFFIC  
CONTROL DEVICES FOR STREETS AND HIGHWAYS

Hunt County Road Crossings

Project consists of approximately:  
5 aerial crossings:  
46', 354', 80', 112', 206'

### GENERAL CONSTRUCTION NOTES

1. ALL CONSTRUCTION WORK WITHIN THE PUBLIC RIGHT-OF-WAY SHALL BE DONE IN ACCORDANCE WITH THE ORDINANCES AND REGULATIONS OF THE JURISDICTION IN WHICH THE WORK IS TO BE PERFORMED.
2. EXISTING UTILITY LOCATIONS SHOWN ARE BASED FROM AVAILABLE RECORDS AND MAY NOT BE ALL INCLUDING. UTILITY LOCATIONS ARE GENERALLY SHOWN AS SHOWN AND MAY NOT ACCURATELY REFLECT THE SIZE AND LOCATION OF EACH PARTICULAR UTILITY. THE CONSTRUCTION CONTRACTOR SHALL ASSUME RESPONSIBILITY FOR ACTUAL LINE LOCATIONS IN THE FIELD AND THE PROTECTION OF ALL EXISTING INCLUDING EXISTING SHOWN OR NOT. THE CONSTRUCTION CONTRACTOR SHALL ALSO ASSUME RESPONSIBILITY FOR DAMAGES TO ANY EXISTING FACILITY CAUSED BY THE DIRECT RESULT OF THE CONSTRUCTION WORKER'S NEGLIGENCE OR INADEQUATE WORKMANSHIP.
3. THE CONSTRUCTION CONTRACTOR SHALL BE RESPONSIBLE FOR OBTAINING ALL NECESSARY PERMITS FROM THE JURISDICTION AND THE UTILITY COMPANIES AT LEAST TWO WEEKS BEFORE THE COMMENCEMENT OF WORK.  
CALL BEFORE YOU DIG  
811  
IT'S THE LAW
4. IT SHALL BE THE RESPONSIBILITY OF THE CONSTRUCTION CONTRACTOR TO AVOID DAMAGE TO PRIVATE AND PUBLIC PROPERTY TO REPAIR ALL AREAS AFFECTED BY THE CONSTRUCTION TO ORIGINAL OR BETTER CONDITION.
5. SURVEYING AND TRAFFIC CONTROL SHALL BE THE RESPONSIBILITY OF THE CONSTRUCTION CONTRACTOR AND SHALL CONFORM TO THE TEXAS MANUAL ON UNIFORM TRAFFIC CONTROL DEVICES, TRAFFIC PLANS AND ACCESS SHALL BE MAINTAINED THROUGHOUT ALL PHASES OF CONSTRUCTION. THE CONSTRUCTION CONTRACTOR IS RESPONSIBLE FOR PROVIDING TRAFFIC SAFETY MEASURES FOR WORK ON THE PROJECT THE WORK SITE SHALL BE SAFELY SET AND DEMARCADED AT NIGHT.
6. THE CONSTRUCTION CONTRACTOR SHALL COMPLY WITH ALL APPLICABLE FEDERAL, STATE AND LOCAL LAWS GOVERNING OPERATIONS. THE CONSTRUCTION CONTRACTOR SHALL PROVIDE ALL TRAFFIC SAFETY PERSONNEL THAT COMPLY WITH ALL LAWS GOVERNING OPERATION. THE CONSTRUCTION CONTRACTOR SHALL BE SOLELY RESPONSIBLE FOR ALL ASPECTS OF WORK RELATED TO CONSTRUCTION.
7. ALL CONCRETE USED IN ANY REPAIRS SHALL BE IN COMPLIANCE WITH THE SPECIFIED CLASS OF CONCRETE IN THE STANDARD SPECIFICATIONS FOR PORTLAND CEMENT CONCRETE "PROVED" AND 7.03 "QUALITY OF CONCRETE" CONSTRUCTION - BIDDING. ALL OTHER CONCRETE SHALL BE CLASS A CONCRETE.
8. ALL REINFORCER BARS AND CORNERS SHALL BE PROTECTED AND SUPPORTED AND MAINTAINED AT THE CORRECT CLEARANCES BY THE USE OF BAR CHAIRS OR OTHER APPROVED SUPPORT.
9. ALL CONCRETE MUST BE PLACED WITH A MINIMUM 4" OF COVER, UNLESS OTHERWISE SPECIFIED.
10. ALL SHOULDER SHALL BE MEDIANLY TRIMMED IN LOTS TO A WIDTH OF 80% PROCTOR. THE REQUIRED WIDTH SHALL BE OBTAINED BY USING TRIMMERS, BROOMS OR ROLLING EQUIPMENT. LOTS WITH MORE ACCORDING TO THE TYPE OF EQUIPMENT USED TO OBTAIN THE REQUIRED WIDTH. SAND AND DEBRIS FREE MATERIAL SHALL BE USED FOR SHOULDER.

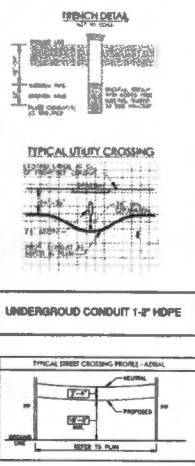

PREPARED BY: DFW TELECOM, INC

17,238 (13)



1565 Chenault Street, Dallas, Texas 75228

January 12, 2022

Office of County Commissioners  
PO BOX 1097  
Greenville, Texas 75403

**Aerial and / or Underground Crossing(s)  
Project PID 3248354**

FILED FOR RECORD  
at 1:30 o'clock P M

JAN 25 2022

BECKY LANDRUM  
County Clerk, Hunt County, Tex.  
By

Greetings,

Spectrum/Charter is requesting permission to construct and placement of fiber which may consist of both underground and aerial attachment to existing poles. This request is for multiple road crossings on county road 3525, which is located in Greenville, Hunt County, Texas.

Site location map and google plans are enclosed. The construction plans detail the proposed work. All road crossings will have a minimum vertical clearance of 18 feet.

If you have any questions, please contact me at any time.

Sincerely,

*Jason Kennedy*  
Project Coordinator  
[Jason.kennedy@charter.com](mailto:Jason.kennedy@charter.com)  
Phone 903-513-2738

Submitted by:  
Dayna LaPoma / Jessie Hatley  
Project Coordinator / RDOF Coordinator  
[Dayna.lapoma@dfw-telecom.com](mailto:Dayna.lapoma@dfw-telecom.com)  
[Jessie.hatley@dfw-telecom.com](mailto:Jessie.hatley@dfw-telecom.com)

Enclosures

County Approval Section:

Approved:  Denied:

Authorized Signature: Date: 1-25-22



# Spectrum

**NOTE**  
CONTRACTOR IS RESPONSIBLE TO MAINTAIN TRAFFIC CONTROL AS SET FORTH IN THE TENSER MANUAL ON UNIFORM TRAFFIC CONTROL DEVICES FOR STREETS AND HIGHWAYS

Hunt County Road Crossings

Project consists of approximately:  
1 aerial crossings:  
136'

### GENERAL CONSTRUCTION NOTES

1. ALL CONSTRUCTION WORK WITHIN THE PUBLIC RIGHT-OF-WAY SHALL BE DONE IN ACCORDANCE WITH THE ORDINANCES AND REGULATIONS OF THE JURISDICTION IN WHICH THE WORK IS TO BE PERFORMED.
2. EXISTING UTILITY LOCATIONS SHOWN ARE BASED UPON AVAILABLE RECORDS AND MAY NOT BE ALL INCLUSIVE. UTILITY LOCATIONS ARE GENERALLY SHOWN IN RED AND MAY NOT ACCURATELY REFLECT THE SIZE AND LOCATION OF EACH PARTICULAR UTILITY. THE CONSTRUCTION CONTRACTOR SHALL ASSUME RESPONSIBILITY FOR ACTUAL LINE LOCATIONS IN THE FIELD AND THE PROTECTION OF ALL EXISTING UTILITIES MATCHED SHOWN ON THIS PLAN. THE CONSTRUCTION CONTRACTOR SHALL ALSO ASSUME RESPONSIBILITY FOR REPORTS TO ANY LOCALITY FACILITY OWNED AS A DIRECT RESULT OF THE CONSTRUCTION SERVICES WHETHER THE FACILITY IS SHOWN ON THE DRAWINGS OR NOT.
3. THE CONSTRUCTION CONTRACTOR SHALL BE RESPONSIBLE FOR CONTACTING ALL DEPARTMENTS WITHIN THE JURISDICTION AND THE UTILITY COMPANIES AT LEAST 720 HOURS BEFORE WORK BEGINS TO THE COMMENCEMENT OF WORK.  
CALL BEFORE YOU DIG  
811  
IT'S THE LAW
4. IT SHALL BE THE RESPONSIBILITY OF THE CONSTRUCTION CONTRACTOR TO ADJUST DRIVEWAYS TO MAINTAIN AND PUBLIC PROPERTY TO RESTORE ALL AREAS AFFECTED BY THE CONSTRUCTION TO ORIGINAL OR BETTER CONDITION.
5. BARRICADES AND TRAFFIC CONTROL SHALL BE THE RESPONSIBILITY OF THE CONSTRUCTION CONTRACTOR AND SHALL CONFORM TO THE TENSER MANUAL ON UNIFORM TRAFFIC CONTROL DEVICES. TRAFFIC FLOW AND ACCESS SHALL BE MAINTAINED THROUGH ALL PHASES OF CONSTRUCTION. THE CONSTRUCTION CONTRACTOR IS RESPONSIBLE FOR PROVIDING TRAFFIC SAFETY MEASURES FOR WORK ON THE PROJECT. THE WORK SITE SHALL BE SAFETY OF AND DEMARCADED AT NIGHT.
6. THE CONSTRUCTION CONTRACTOR SHALL ABIDE BY ALL APPLICABLE FEDERAL, STATE AND LOCAL LAWS GOVERNING EDUCATION. THE CONSTRUCTION CONTRACTOR SHALL PROVIDE ALL TRUCK SAFETY TRAINING THAT COMPLY WITH ALL LAWS GOVERNING EDUCATION. THE CONSTRUCTION CONTRACTOR SHALL BE SOLELY RESPONSIBLE FOR ALL ASPECTS OF WORK RELATED TO EDUCATION.
7. ALL CONCRETE USED IN ANY FOOTING SHALL BE IN COMPLIANCE WITH THE SPECIFIED CLASS OF CONCRETE IN THE DRAWING SPECIFICATIONS. ALL PORTLAND CEMENT CONCRETE FINISHES AND 7.4.5 "QUALITY OF CONCRETE" CONSTRUCTION - 2004. ALL OTHER CONCRETE SHALL BE CLASS A CONCRETE.
8. ALL REINFORCING STEEL AND CONCRETE SHALL BE PROVIDED AND MAINTAINED AT THE CORRECT CLEARANCES BY THE USE OF SURE CHAIRS OR OTHER APPROVED SUPPORT.
9. ALL CONDUIT MUST BE PLACED WITH A MINIMUM 4" OF COVER, UNLESS OTHERWISE SPECIFIED.
10. ALL BROADCASTING SHALL BE NECESSARILY MARKED IN LETTERS TO A DEPTH OF ONE FOOT. THE REQUIRED DEPTH WILL BE DETERMINED BY WIND, TEMPERATURE, WINDS OF SOLAR CORRELATION. LETTERS MUST BE ACCORDING TO THE TYPE OF EQUIPMENT USED TO BRUSH THE REQUIRED DEPTH. SAND AND SEEDS FREE MATERIAL SHALL BE USED FOR BROADCASTING.

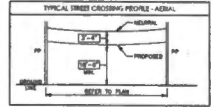
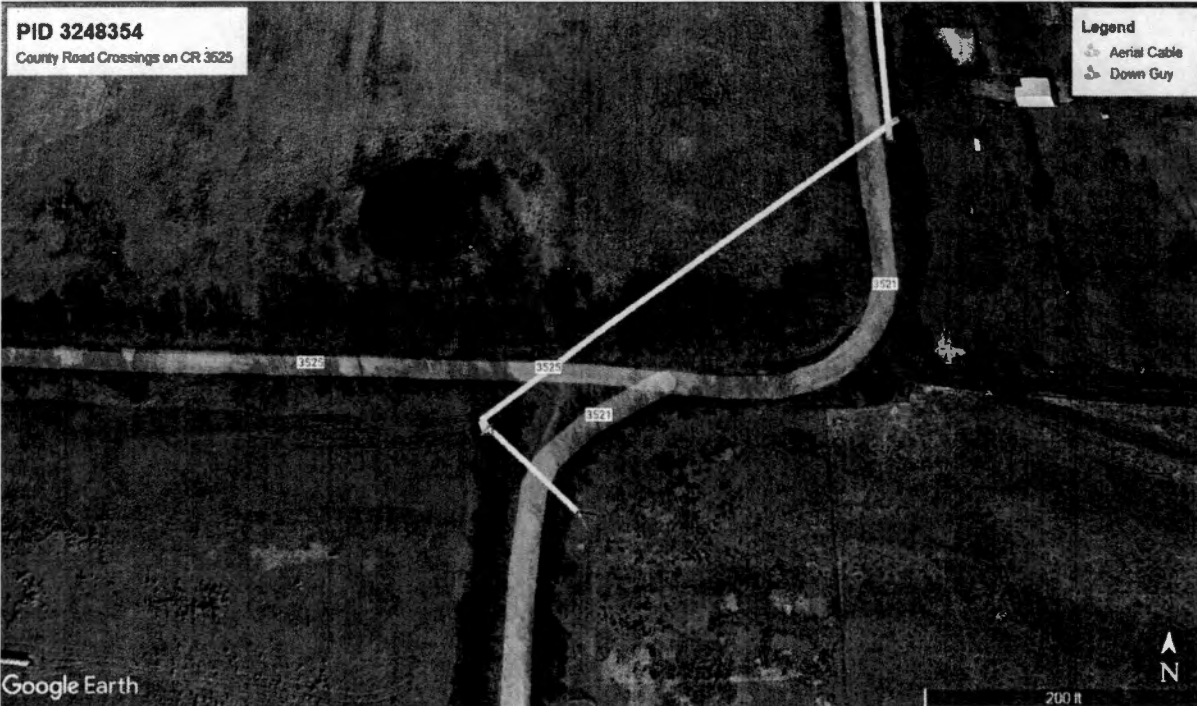

PREPARED BY: DFW TELECOM, INC

17,238 (14)



1565 Chenault Street, Dallas, Texas 75228

January 12, 2022

Office of County Commissioners  
PO BOX 1097  
Greenville, Texas 75403

FILED FOR RECORD  
at 1:30 o'clock P M

JAN 25 2022

**Aerial and / or Underground Crossing(s)  
Project PID 3248354**

BECKY LANDRUM  
County Clerk, Hunt County, Tex.  
By

Greetings,

Spectrum/Charter is requesting permission to construct and placement of fiber which may consist of both underground and aerial attachment to existing poles. This request is for multiple road crossings on county road 3326, which is located in Greenville, Hunt County, Texas.

Site location map and google plans are enclosed. The construction plans detail the proposed work. All road crossings will have a minimum vertical clearance of 18 feet.

If you have any questions, please contact me at any time.

Sincerely,

*Jason Kennedy*  
Project Coordinator  
[Jason.kennedy@charter.com](mailto:Jason.kennedy@charter.com)  
Phone 903-513-2738

Submitted by:  
Dayna LaPoma / Jessie Hatley  
Project Coordinator / RDOF Coordinator  
[Dayna.lapoma@dfw-telecom.com](mailto:Dayna.lapoma@dfw-telecom.com)  
[Jessie.hatley@dfw-telecom.com](mailto:Jessie.hatley@dfw-telecom.com)

Enclosures

County Approval Section:

Approved:  Denied:

Authorized Signature: Date: 1-25-22

# Spectrum

**NOTE**  
CONTRACTOR IS RESPONSIBLE TO MAINTAIN TRAFFIC CONTROL AS SET FORTH IN THE TOWNSHIP OR UNIFORM TRAFFIC CONTROL DEVICES FOR STREETS AND HIGHWAYS.

Hunt County Road Crossings

Project consists of approximately:  
5 aerial crossings:  
217'  
142'  
44'  
78'  
248'

### GENERAL CONSTRUCTION NOTES

1. ALL CONSTRUCTION WORK NEAR THE PUBLIC RIGHT-OF-WAY SHALL BE DONE IN ACCORDANCE WITH THE ORDINANCES AND REGULATIONS OF THE JURISDICTION IN WHICH THE WORK IS TO BE PERFORMED.
2. EXISTING UTILITY LOCATIONS SHOWN ARE BASED UPON AVAILABLE RECORDS AND MAY NOT BE FULLY ACCURATE. ONLY LOCATIONS ARE SHOWN AS SHOWN AND NOT NEARLY APPROXIMATE. THE SIZE AND LOCATION OF EACH UTILITY SHALL BE THE RESPONSIBILITY OF THE CONTRACTOR. THE CONTRACTOR SHALL MAINTAIN RECORDS FOR ALL UTILITIES LOCATED IN THE FIELD AND THE PROVISIONS OF ALL ORDINANCES APPLICABLE TO SUCH RECORDS. THE CONTRACTOR SHALL ALSO MAINTAIN RESPONSIBILITY FOR THE PROTECTION OF ALL UTILITIES LOCATED AS A RESULT OF THE CONSTRUCTION ACTIVITIES WHETHER THE UTILITY IS SHOWN ON THE DRAWINGS OR NOT.
3. THE CONTRACTOR CONTRACTOR SHALL BE RESPONSIBLE FOR OBTAINING ALL NECESSARY PERMITS FROM THE JURISDICTION AND THE UTILITY COMPANIES AT LEAST TWO WEEKS PRIOR TO THE COMMENCEMENT OF WORK. CALL BEFORE YOU DIG 811 17'S THE LAW.
4. IT SHALL BE THE RESPONSIBILITY OF THE CONTRACTOR TO PROTECT ALL EXISTING UTILITIES AND PUBLIC PROPERTY. IT SHALL BE THE RESPONSIBILITY OF THE CONTRACTOR TO OBTAIN ALL NECESSARY PERMITS.
5. SURVEYING AND SURVEY CONTROL SHALL BE THE RESPONSIBILITY OF THE CONTRACTOR CONTRACTOR AND SHALL BE SUBJECT TO THE TOWNSHIP OR UNIFORM TRAFFIC CONTROL. TRAFFIC PLAN AND ACCESS SHALL BE MAINTAINED DURING ALL PHASES OF CONSTRUCTION. THE CONTRACTOR CONTRACTOR IS RESPONSIBLE FOR MAINTAINING TRAFFIC CONTROL FOR WORK ON THE PROJECT. THE WORK SITE SHALL BE SAFELY AND SECURELY FENCED OFF.
6. THE CONTRACTOR CONTRACTOR SHALL ABIDE BY ALL APPLICABLE FEDERAL, STATE AND LOCAL LAWS GOVERNING CONSTRUCTION. THE CONTRACTOR CONTRACTOR SHALL MAINTAIN ALL NECESSARY SAFETY EQUIPMENT AND ALL LAWS GOVERNING CONSTRUCTION. THE CONTRACTOR CONTRACTOR SHALL BE SOLELY RESPONSIBLE FOR ALL ASPECTS OF WORK RELATED TO CONSTRUCTION.
7. ALL CONCRETE USED IN ANY FOOTING SHALL BE IN COMPLIANCE WITH THE SPECIFIED CLASS OF CONCRETE IN THE STANDARD SPECIFICATIONS FOR PORTLAND CEMENT CONCRETE AND 7.4.3 QUALITY OF CONCRETE AS SPECIFIED BY THE CONTRACTOR TO THE SOUTH TEXAS POWER TRANSMISSION PROJECT FOR PUBLIC UTILITY CONSTRUCTION - 2004. ALL OTHER CONCRETE SHALL BE CLASS A CONCRETE.
8. ALL REINFORCING BARS AND CABLE SHALL BE PROVIDED AND INSTALLED BY THE CONTRACTOR CONTRACTOR IN ACCORDANCE WITH THE TYPE OF THE DESIGN OR OTHER APPLICABLE SPECIFICATIONS.
9. ALL CABLES MUST BE PLACED WITH A MINIMUM 4" OF COVER UNLESS OTHERWISE SPECIFIED.
10. ALL STRUCTURES SHALL BE NECESSARILY THINER IN WIDTH TO A MINIMUM OF 18" UNLESS OTHERWISE SPECIFIED. WIDTH SHALL BE DETERMINED BY UTILITY TRANSMISSION OR ROLLING EQUIPMENT WIDTHS AND MUST ACCORDING TO THE TYPE OF EQUIPMENT USED TO OBTAIN THE REQUIRED WIDTH. SAND AND STONE FINE MATERIAL SHALL BE USED FOR BACKFILL.



17,238 (15)



1565 Chenault Street, Dallas, Texas 75228

January 12, 2022

Office of County Commissioners  
PO BOX 1097  
Greenville, Texas 75403

**Aerial and / or Underground Crossing(s)  
Project PID 3248354**

FILED FOR RECORD  
at 1:30 o'clock P M

JAN 25 2022

BECKY LANDRUM  
County Clerk, Hunt County, Tex.  
By 

Greetings,

Spectrum/Charter is requesting permission to construct and placement of fiber which may consist of both underground and aerial attachment to existing poles. This request is for multiple road crossings on county road 3327, which is located in Greenville, Hunt County, Texas.

Site location map and google plans are enclosed. The construction plans detail the proposed work. All road crossings will have a minimum vertical clearance of 18 feet.

If you have any questions, please contact me at any time.

Sincerely,

*Jason Kennedy*  
Project Coordinator  
[Jason.kennedy@charter.com](mailto:Jason.kennedy@charter.com)  
Phone 903-513-2738

Submitted by:  
Dayna LaPoma / Jessie Hatley  
Project Coordinator / RDOF Coordinator  
[Dayna.lapoma@dfw-telecom.com](mailto:Dayna.lapoma@dfw-telecom.com)  
[Jessie.hatley@dfw-telecom.com](mailto:Jessie.hatley@dfw-telecom.com)

Enclosures

County Approval Section:

Approved:  Denied: \_\_\_\_\_

Authorized Signature: \_\_\_\_\_ Date: 1-25-22



# Spectrum

NOTE  
CONTRACTOR IS RESPONSIBLE TO MAINTAIN TRAFFIC CONTROL,  
AS SET FORTH IN THE TEXAS MANUAL ON UNIFORM TRAFFIC  
CONTROL DEVICES FOR STREETS AND HIGHWAYS

Project consists of approximately:  
4 aerial crossings:  
240'  
209'  
228'  
327'

Hunt County Road Crossings

### GENERAL CONSTRUCTION NOTES

1. ALL CONSTRUCTION SHALL BE IN ACCORDANCE WITH THE SPECIFICATIONS AND REQUIREMENTS OF THE BLUEPRINTS AS ISSUED BY THE ENGINEER.
2. EXISTING UTILITY LOCATIONS SHOWN ARE BASED ON AVAILABLE RECORDS AND MAY NOT BE ALL INCLUDING UNPLAT LOCATIONS AND ARE NOT NECESSARILY REFLECT THE SIZE AND LOCATION OF SUCH PARTICULAR UTILITIES. THE CONSTRUCTION CONTRACTOR SHALL ASSUME RESPONSIBILITY FOR VERIFYING THE LOCATION AND DEPTH OF ALL UTILITIES PRIOR TO ANY CONSTRUCTION WORK.
3. THE CONSTRUCTION CONTRACTOR SHALL BE RESPONSIBLE FOR OBTAINING ALL NECESSARY PERMITS FROM THE MUNICIPALITY AND THE UTILITY COMPANIES AT LEAST TWO WEEKS PRIOR TO THE COMMENCEMENT OF WORK.
4. IT SHALL BE THE RESPONSIBILITY OF THE CONSTRUCTION CONTRACTOR TO PROVIDE BARRIERS TO PROTECT PRIVATE AND PUBLIC PROPERTY TO REMAIN AS WELL AS TO PROTECT THE CONSTRUCTION WORK.
5. BARRIERS AND TRAFFIC CONTROL SHALL BE THE RESPONSIBILITY OF THE CONSTRUCTION CONTRACTOR AND SHALL CONFORM TO THE TEXAS MANUAL ON UNIFORM TRAFFIC CONTROL DEVICES. TRAFFIC FLOW AND ACCESS SHALL BE MAINTAINED DURING ALL PHASES OF CONSTRUCTION. THE CONSTRUCTION CONTRACTOR IS RESPONSIBLE FOR PROVIDING TRAFFIC SAFETY MEASURES FOR WORK ON THE PROJECT. THE WORK SITE SHALL BE SAFELY PLACED AND BARRICADED AT NIGHT.
6. THE CONSTRUCTION CONTRACTOR SHALL HOLD BY ALL APPLICABLE FEDERAL, STATE AND LOCAL LAWS GOVERNING EDUCATION. THE CONSTRUCTION CONTRACTOR SHALL PROVIDE ALL TRAFFIC SAFETY SYSTEMS THAT COMPLY WITH ALL LAWS CONCERNING EDUCATION. THE CONSTRUCTION CONTRACTOR SHALL BE SOLELY RESPONSIBLE FOR ALL ASPECTS OF WORK RELATED TO EDUCATION.
7. ALL CONCRETE USED IN ANY ROADWAY SHALL BE IN COMPLIANCE WITH THE SPECIFIED CLASSES OF CONCRETE IN THE EXISTING SPECIFICATIONS I.E. "NORMAL CEMENT CONCRETE" AND "HIGH STRENGTH CONCRETE" AS INDICATED BY THE ARCHITECT TO THE JOINT CONTRACTING. TENSILE STRENGTH SPECIFICATIONS FOR PUBLIC WORKS CONSTRUCTION - 2008. ALL OTHER CONCRETE SHALL BE CLASS A CONCRETE.
8. ALL REINFORCING BARS AND CATCH BARS IN PRECAST SHALL BE SUPPLIED AND MAINTAINED AT THE CORRECT CLEARANCES BY THE USE OF BAR CHAIRS OR OTHER APPROVED SUPPORT.
9. ALL CONCRETE MUST BE PLACED WITH A MINIMUM 4" OF COVER UNLESS OTHERWISE SPECIFIED.
10. ALL REINFORCING SHALL BE NECESSARILY TIED IN PLACE TO A MINIMUM OF ONE POSITION. THE REQUIRED TIE BAR SHALL BE PROVIDED BY THE CONTRACTOR. THE CONTRACTOR SHALL BE RESPONSIBLE FOR THE TYPE OF CONCRETE USED TO OBTAIN THE REQUIRED STRENGTH. SAND AND GRAVEL FILL MATERIAL SHALL BE USED FOR BACKFILL.

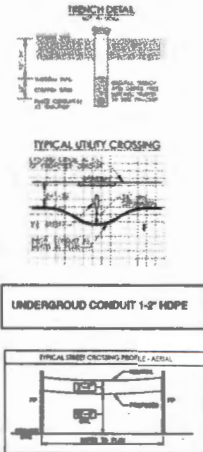
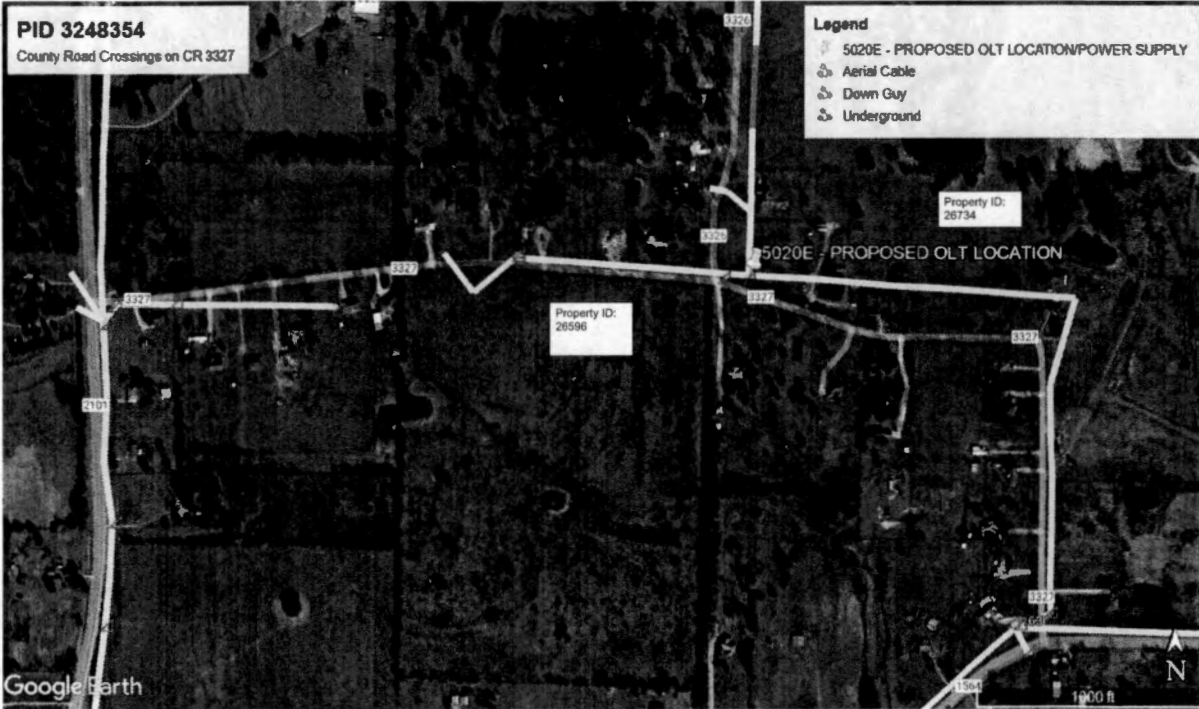

PREPARED BY: DFW TELECOM, INC